

	P	O	N	M	L	K	J	I	H	G	F	E	D	C	B	A		
DEG.			✓								版次	修改内容			修改	审核	批准	日期
DIV.	A	B	C	D	ANGLE						AO	第一次发行						
0~5	±0.02	±0.05	±0.1	±0.2	0~30°	±0.1°												
5~10	±0.05	±0.1	±0.15	±0.5	31°~60°	±0.3°												
10~50	±0.1	±0.15	±0.2	±0.5	61°~90°	±0.5°												
50~500	±0.15	±0.2	±0.25	±0.5														
500~	±0.15%	±0.2%	±0.25%	±1.0														

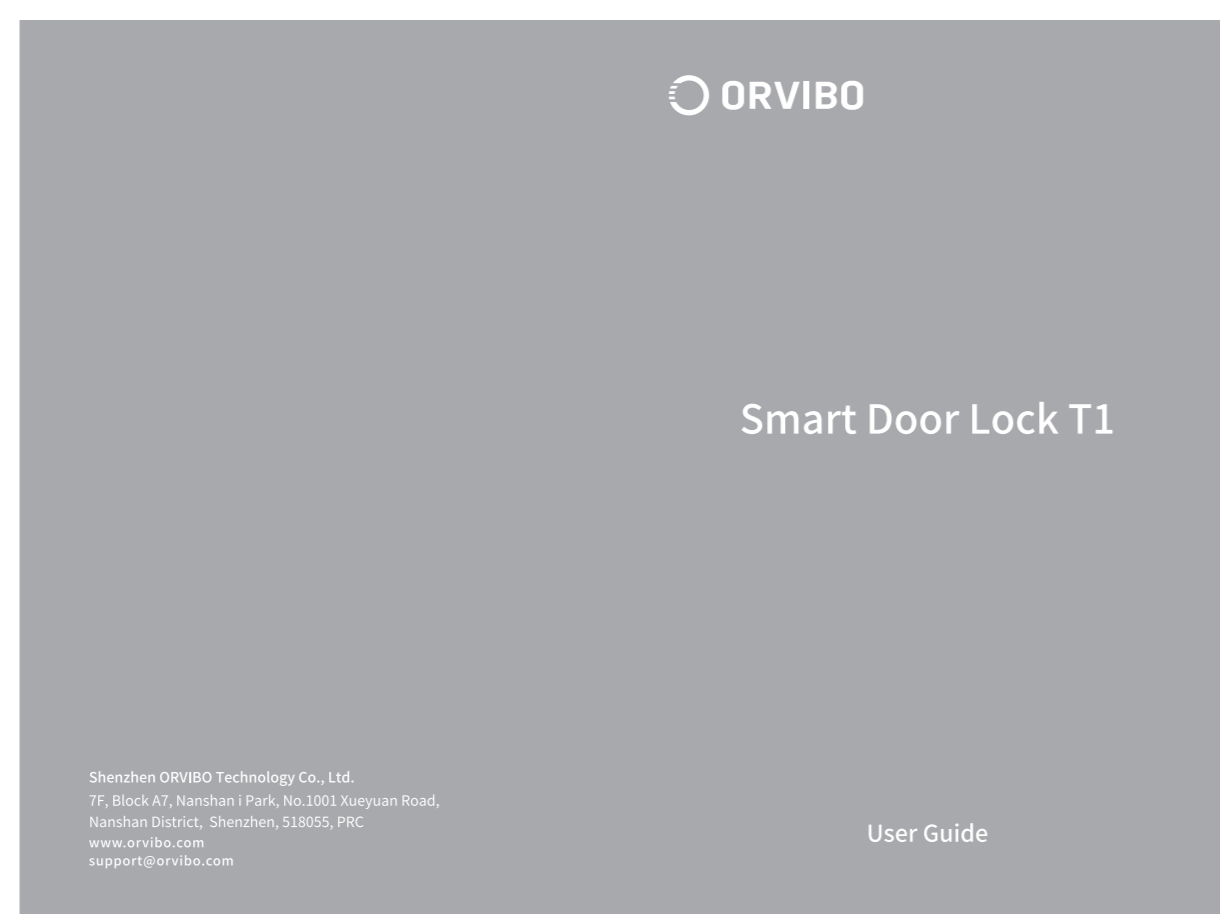

封底

封面

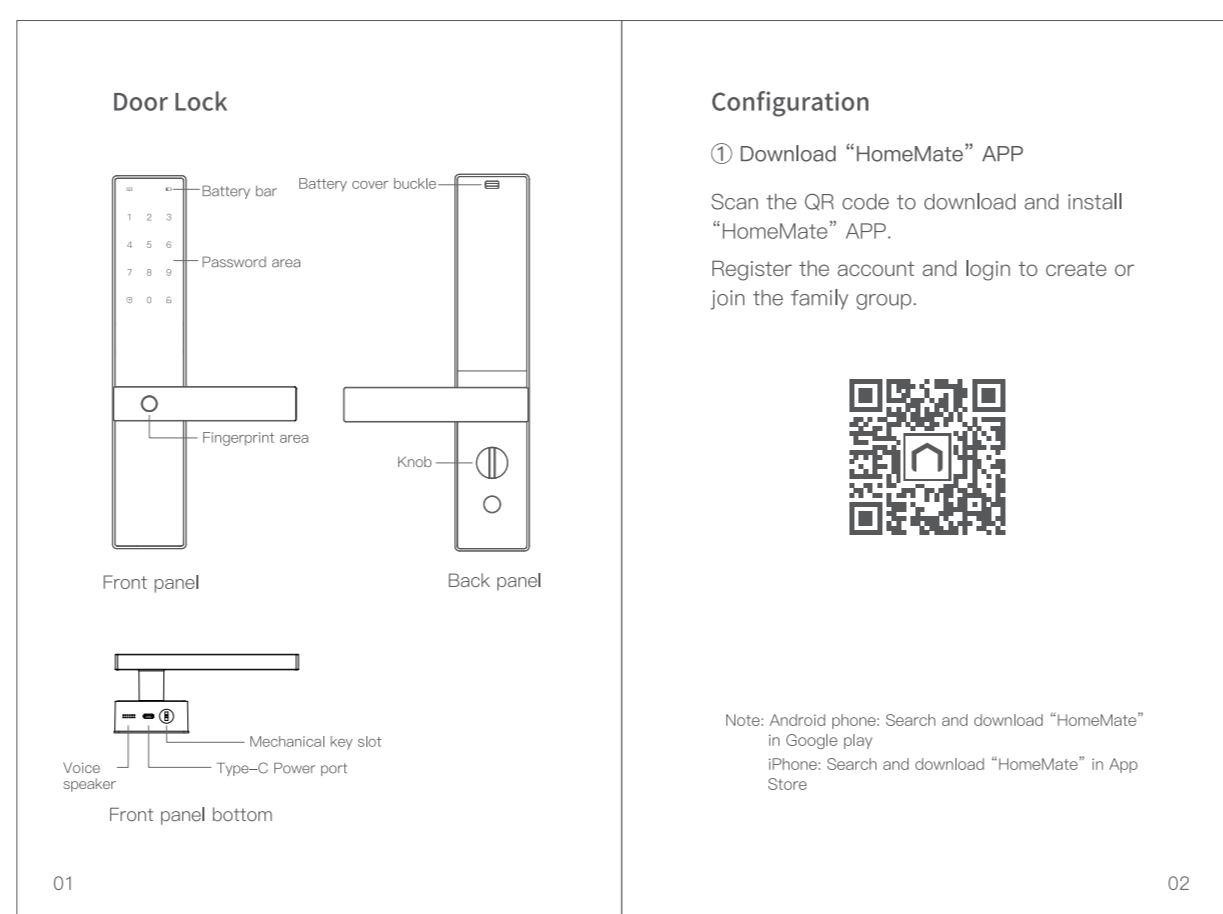

封二

Page 1

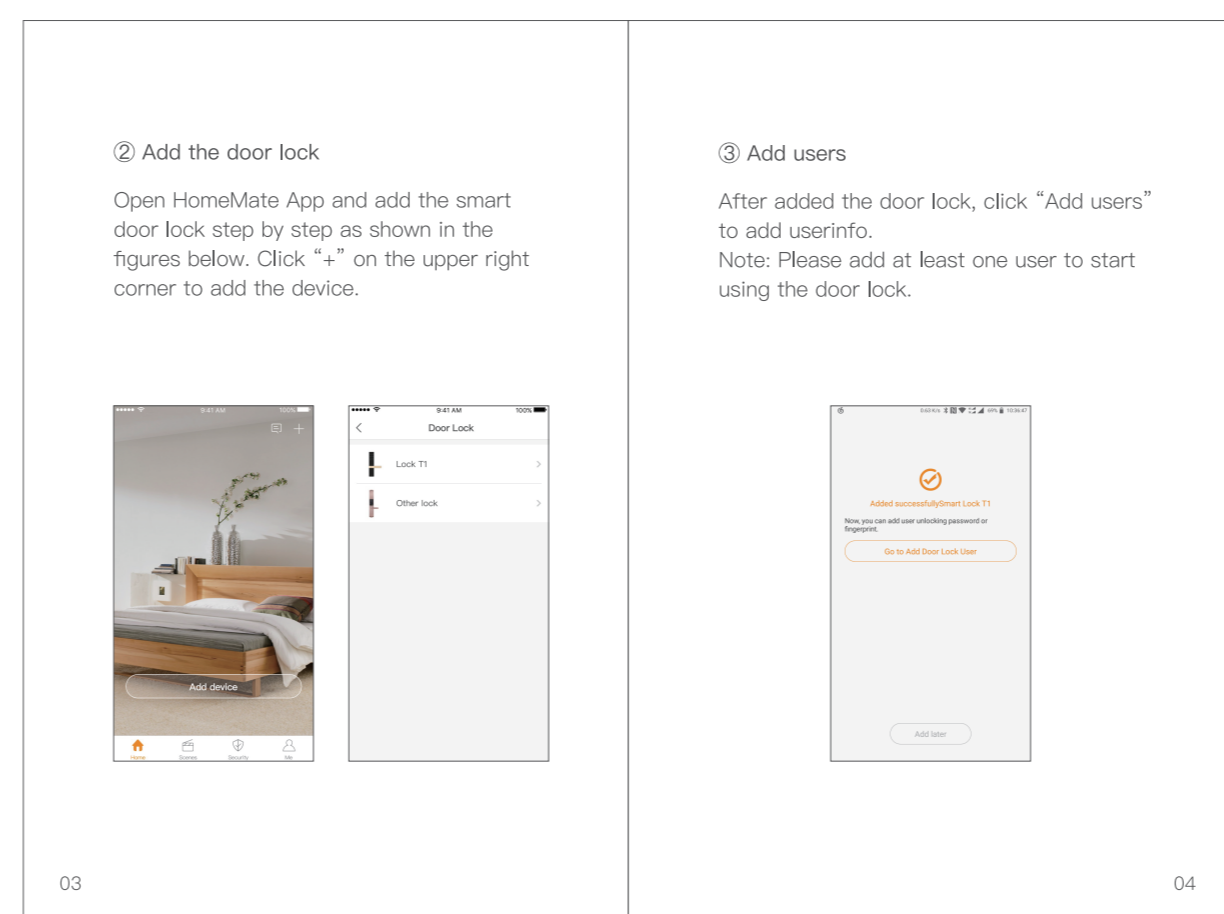

Page 2

Page 3

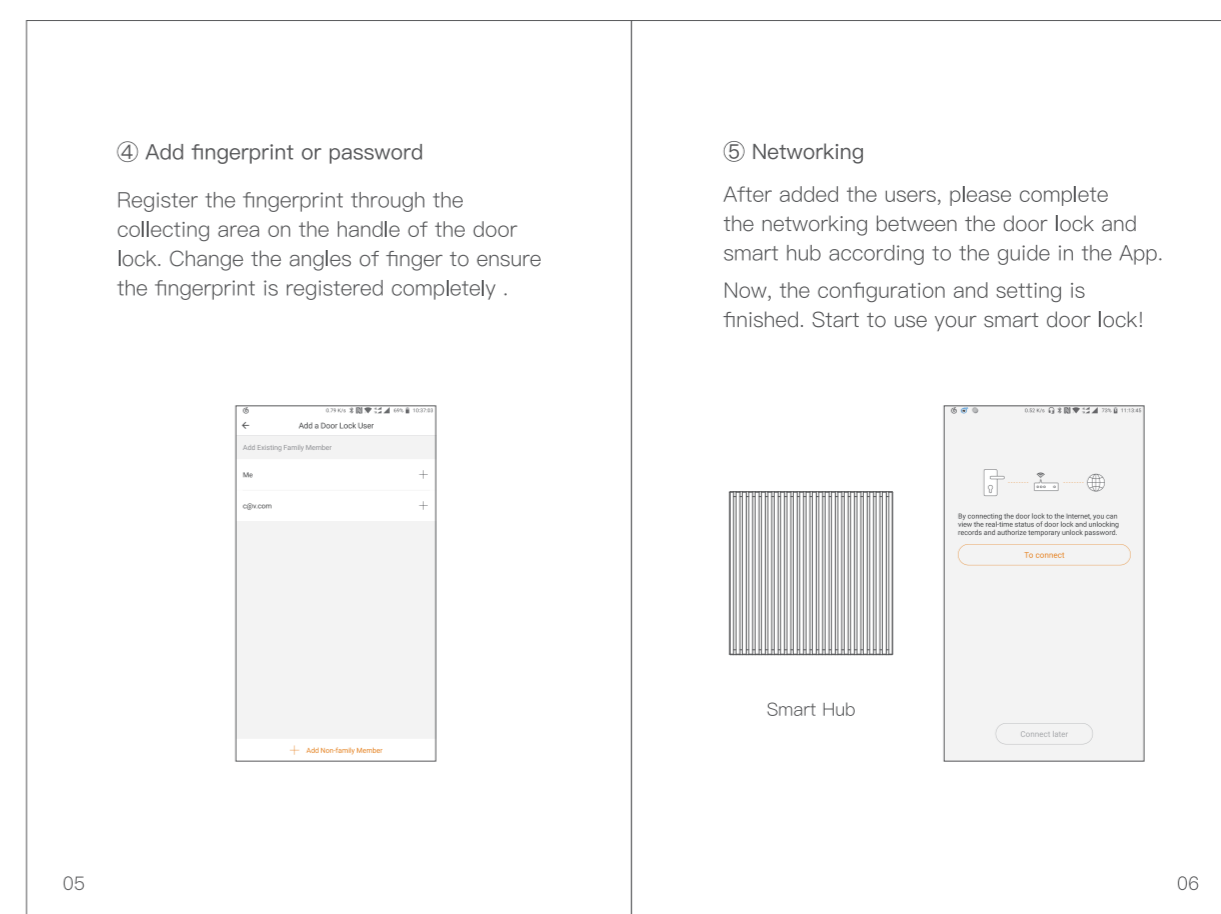

Page 4

Page 5

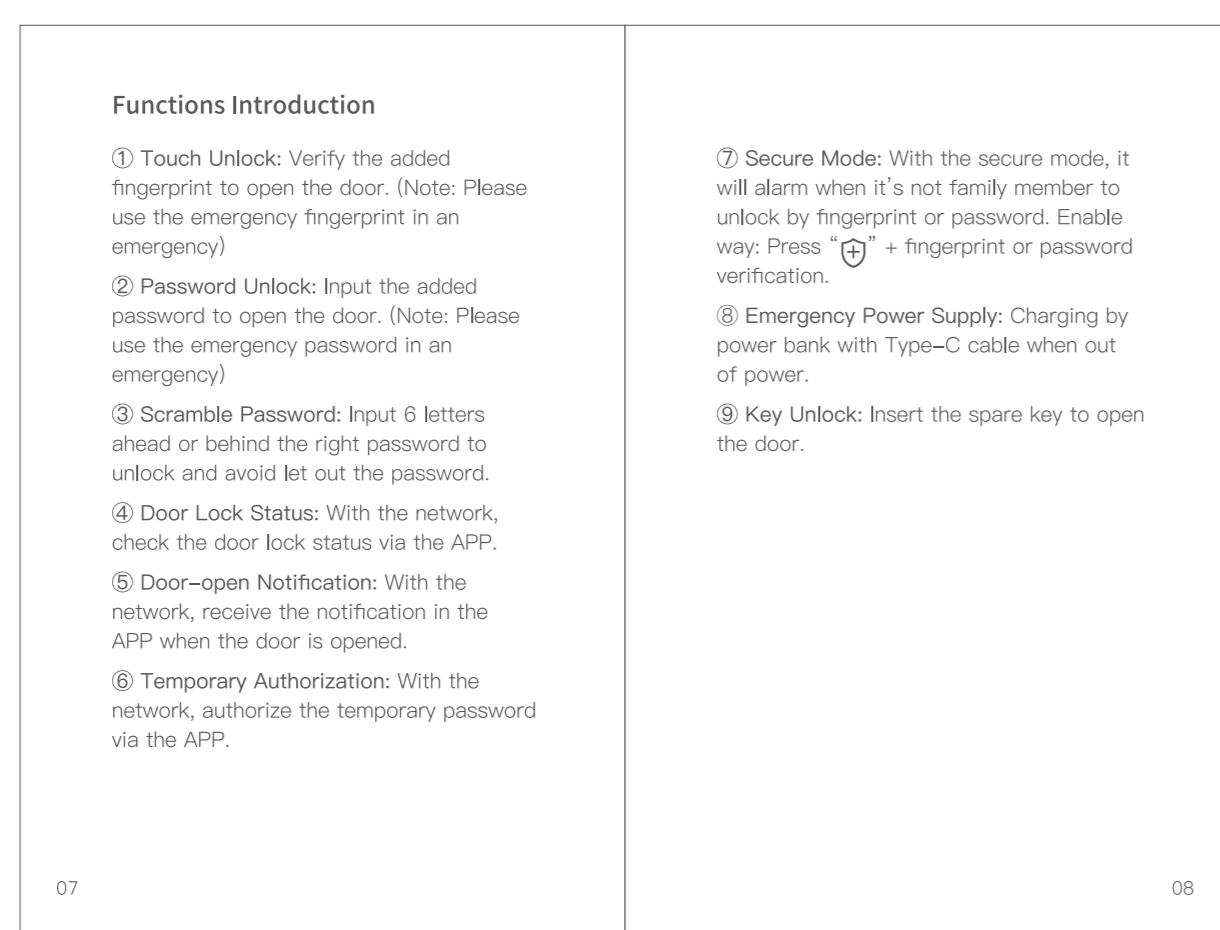

Page 6

Page 7

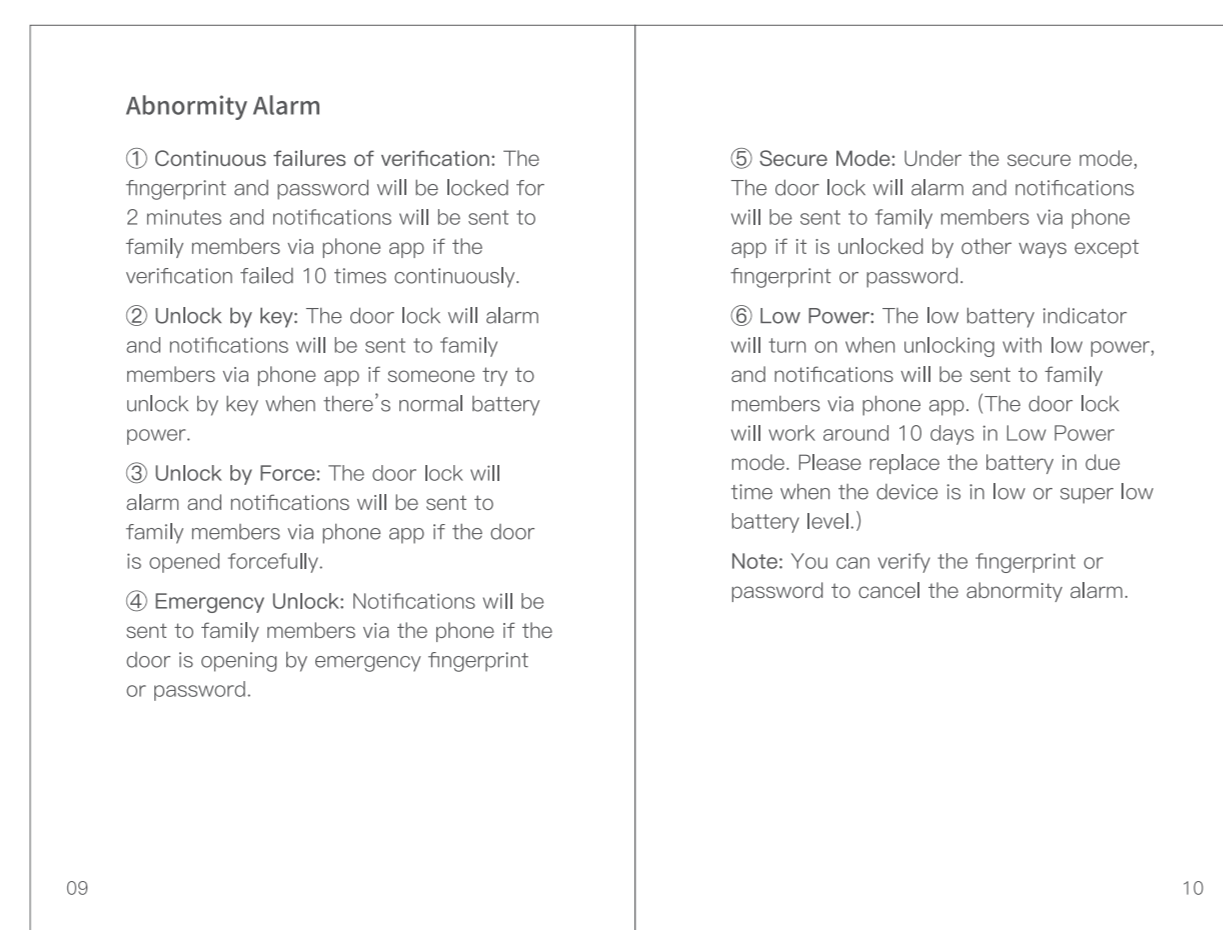

Page 8

Page 9

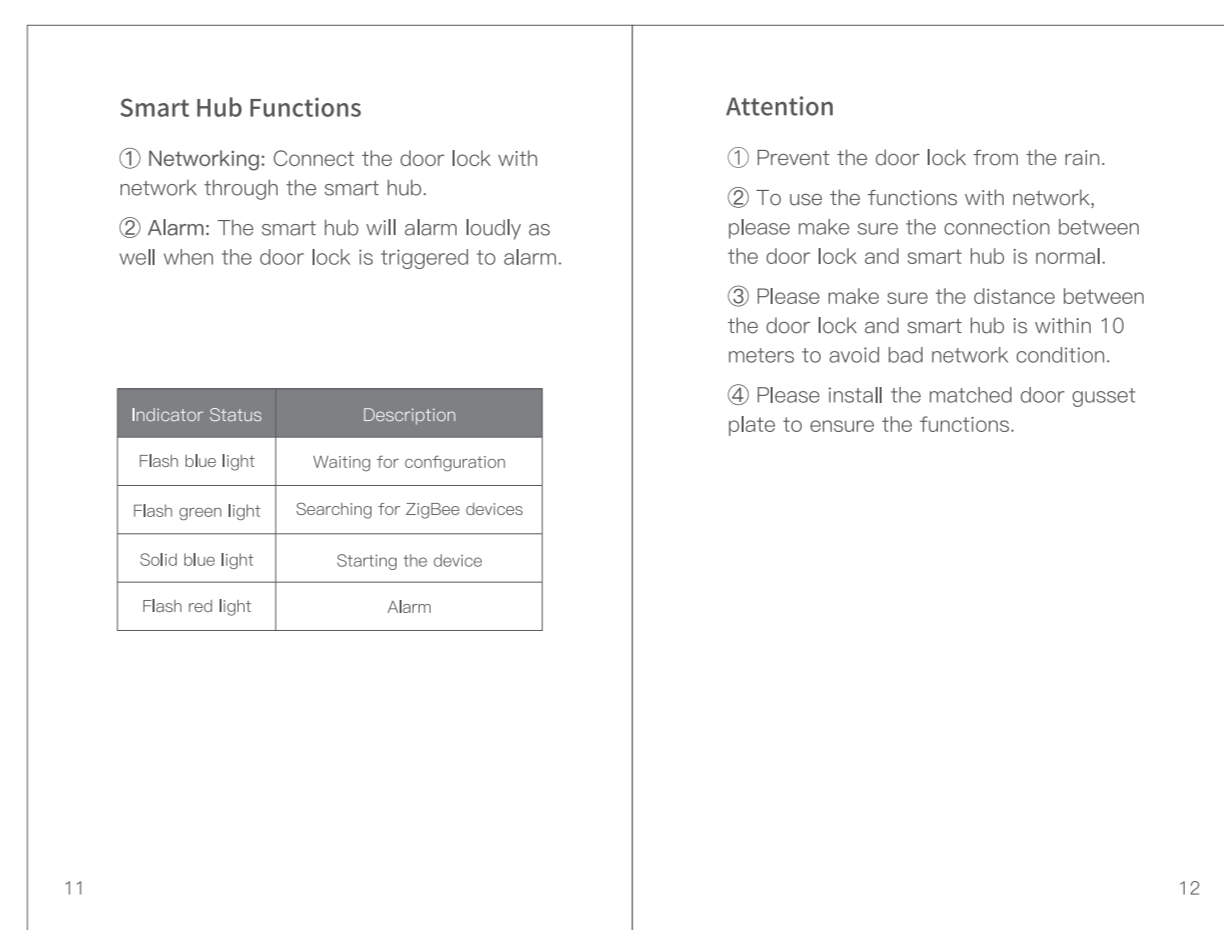

Page 10

Page 11

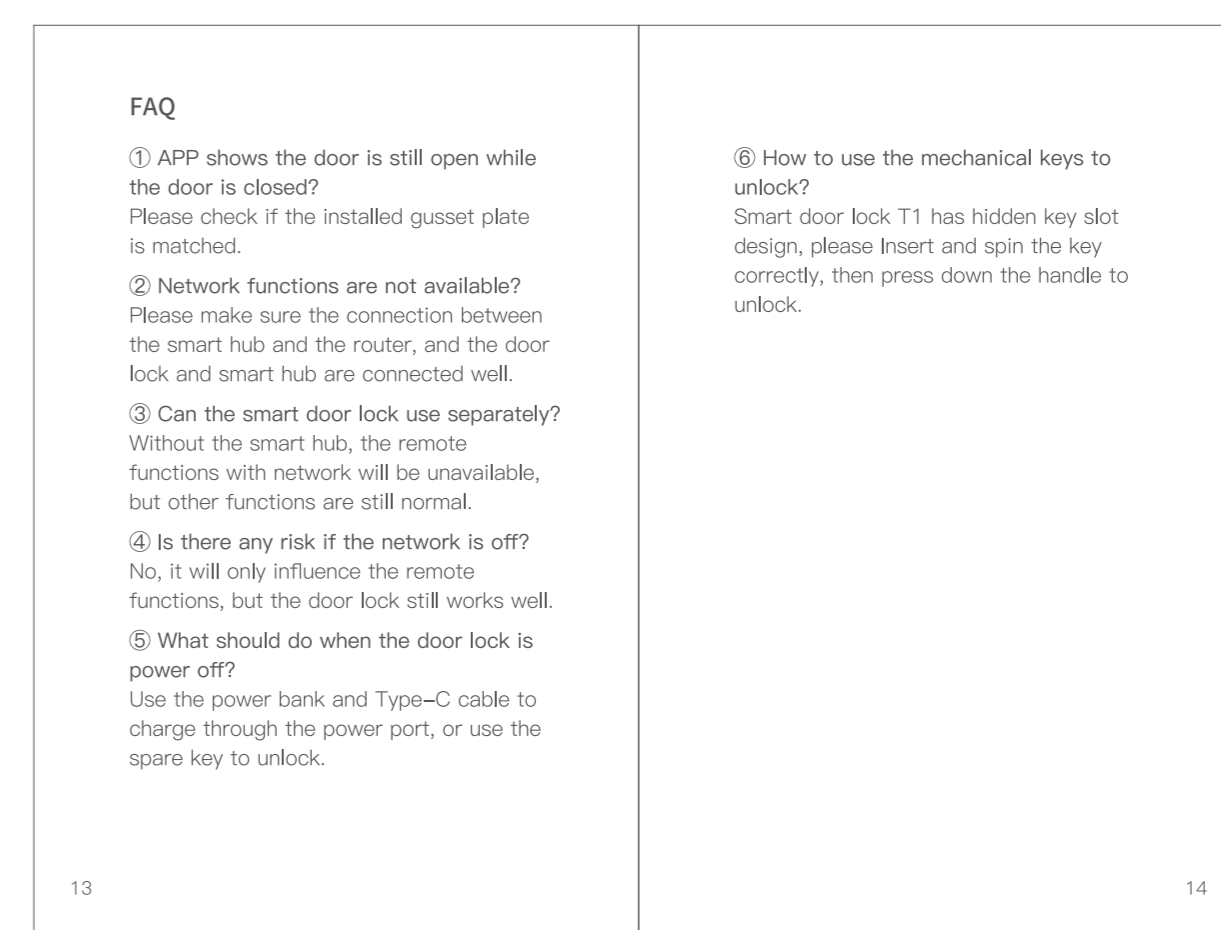

Page 12

Page 13

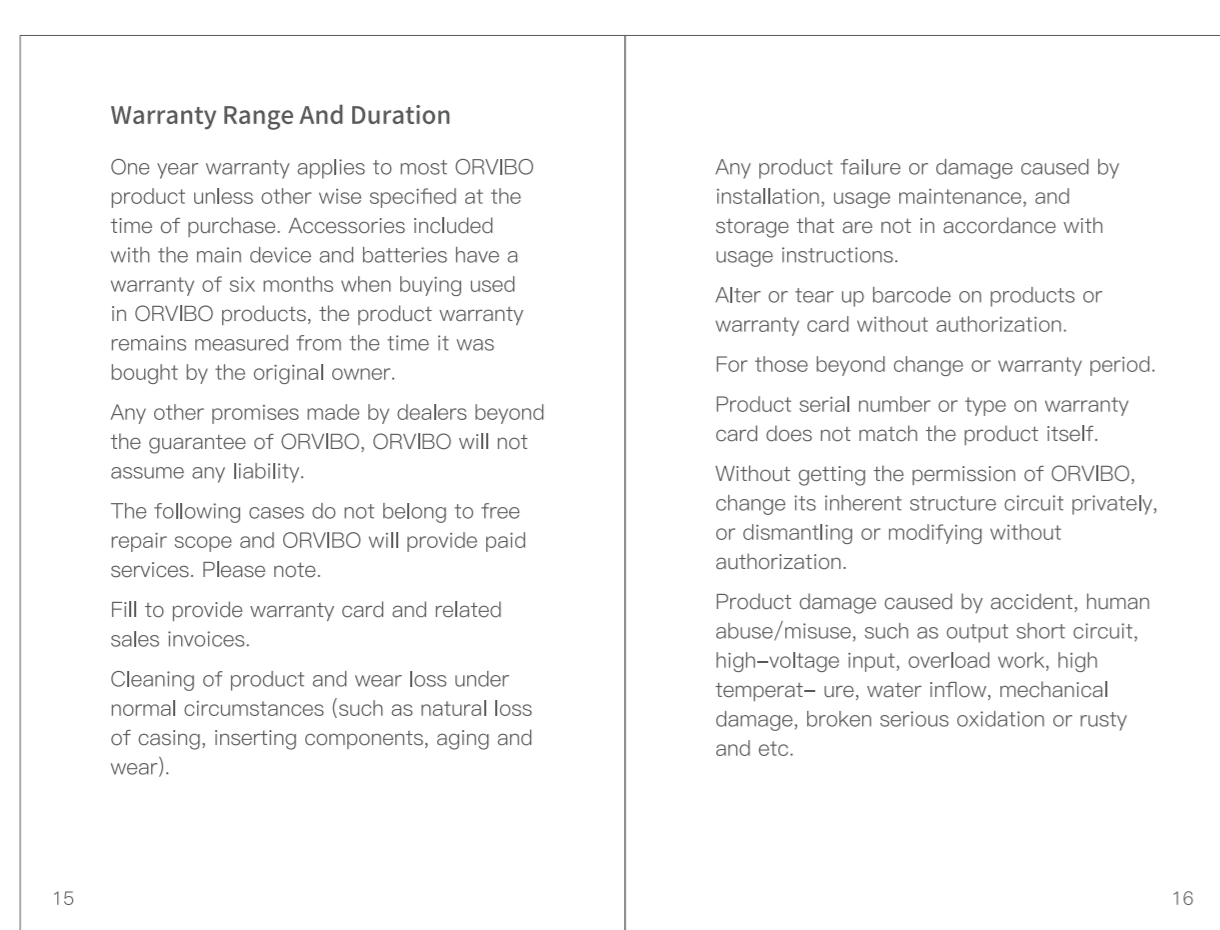

Page 14

Page 15

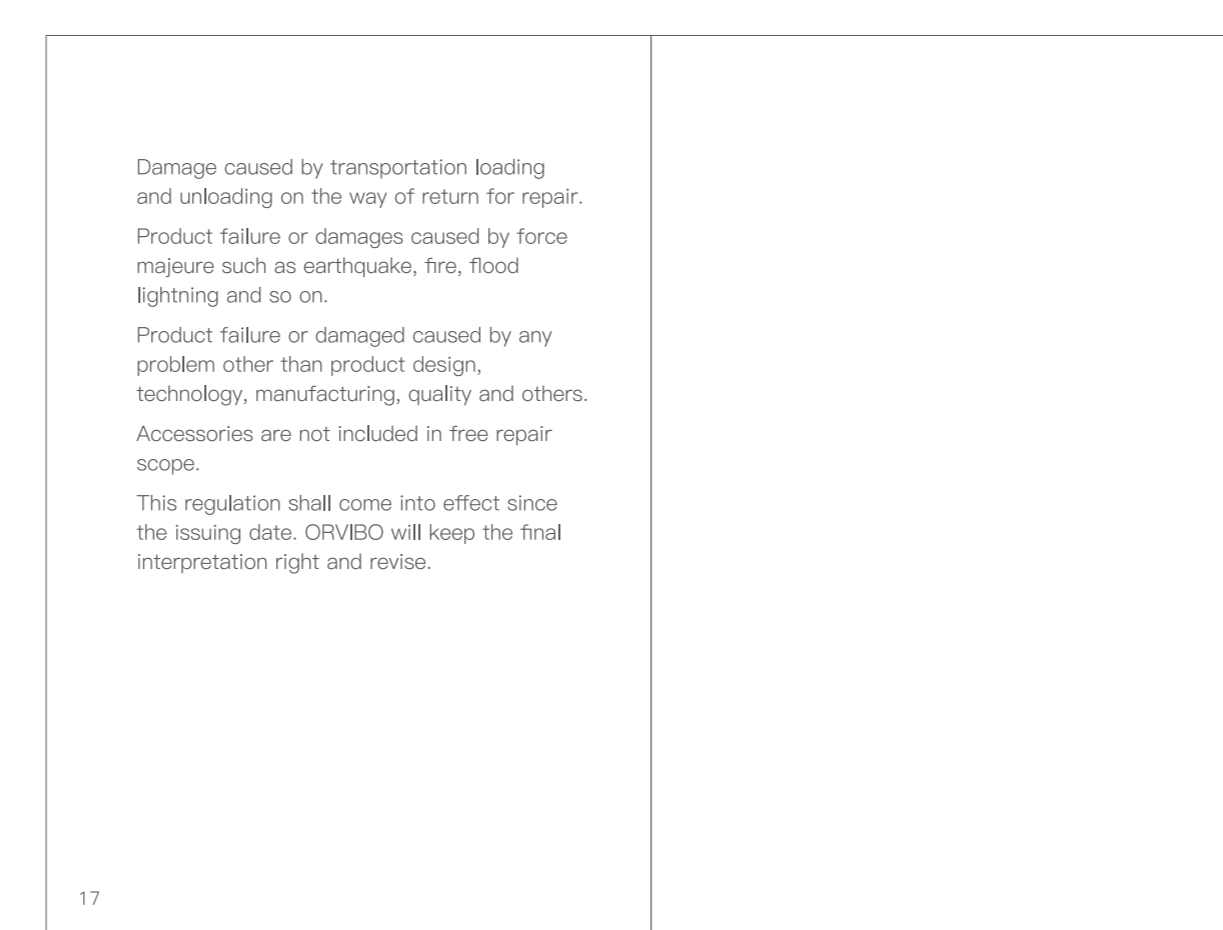

Page 16

封三

备注:

1. 材质: 105g双粉
2. 尺寸: 80\*120mm
3. 印刷: 黑色双面印刷
4. 装订要求: 骑马钉
5. 边框线为折痕线

未注公差: ≤10mm ±0.05mm ≤50mm ±0.1mm >50mm ±0.2mm	制图	审核	批准	产品名称	T1智能门锁使用说明书(英文)	材料	
	吴意			产品料号	3.06.XXXXXX	版次	A0
单位	mm	日期	10-Apr-18	<b>深圳市欧瑞博科技有限公司</b> SHENZHEN ORVIBO TECH CO.,LTD. TEL:+86-0755-85277097 FAX:+86-0755-85277087			