



eldes

EWK2/EWK2A
WIRELESS KEYFOB

User manual v1.3

CONTENTS OF PACK

| Item | Quantity |
|-----------------------------------|----------|
| 1. EWK2/EWK2A..... | 1 |
| 2. CR2032 3V lithium battery..... | 1 |
| 3. User manual..... | 1 |
| 4. Keychain..... | 1 |

Main features:

- Alarm system arming & disarming;
- PGM output control;
- Partition switch;
- Stay Arm;
- Visual and audio indication of command status.

1. GENERAL INFORMATION

EWK2/EWK2A is a wireless device intended to remotely arm and disarm ELDES alarm system, cause system alarm (EWK2A Panic Alarm) or to control any electric appliance connected to the alarm system's PGM output (EWK2). The maximum wireless connection range is 150m (492.13ft) (in open areas). By default, one pair of EWK2 buttons is already configured to arm and disarm the alarm system (configurable). ELDES alarm system supports up to 16 EWK2/EWK2A devices with the same configuration (Public configuration) or up to 5 EWK2/EWK2A devices with custom configuration (Private configuration).

2. TECHNICAL SPECIFICATIONS

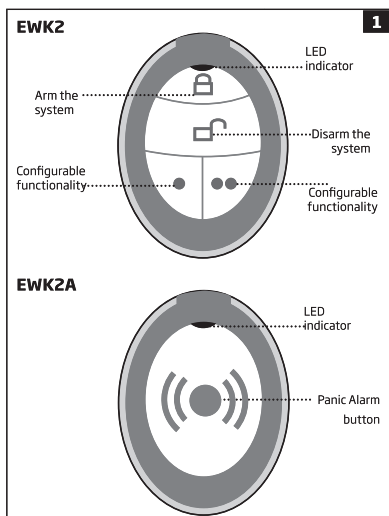

NOTE: Pic. No. 1 reflects the default EWK2/EWK2A button configuration. All keyfob buttons are configurable according to individual needs via *Eldes Utility* software.

2.1. Electrical & Mechanical Characteristics

| | |
|------------------------------|---|
| Battery type..... | 3V Lithium CR2032 type 5004LC (ANSI/NEDA) |
| Quantity of batteries..... | 1 |
| Battery operation time | ~18 months* |
| Wireless band | ISM868/ISM915 |
| Range of operating | -10...+55 °C (14...+131°F) temperatures |
| Humidity..... | 0-90% RH @ 0...+40°C (0-90% RH @ +32...+104°F) (non-condensing) |
| Dimensions | 53x37x12mm (2.09x1.46x0.47in) |
| Wireless..... | Up to 150m (492.13ft) in open areas |
| Compatible with..... | PITBULL ALARM PRO and ESIM384 (all FW versions) |

* This operation time can be achieved by pressing the keyfob button up to 4 times per day. The operation time depends on different conditions and may vary.

3. HOW TO USE:

- In order to start using wireless keyfob EWK2/EWK2A, it has to be paired with ELDES alarm system using *ELDES Utility* software.

- EWK2 keyfob features 4 configurable buttons intended to operate according to individual needs, while EWK2A keyfob model features one configurable button.

- After the button is pressed, EWK2/EWK2A internal buzzer's **1 short beep** sound (EWK2A buzzer sound disabled by default) and a single red LED indicator flash confirms a transferred command to ELDES alarm system via wireless connection. Otherwise, **1 long beep** sound and a single red LED indicator flash will inform about unsuccessful attempt to transfer command (presuming that there is no wireless connection to the alarm system).

- The status of the sent command can be checked by attempting to receive the feedback signal from the alarm system (valid **only for Arm/Disarm** commands). This can be performed by **pressing and holding down** the same button for a couple of seconds, **until the keyfob sounds**:

A) 3 short beep sounds and LED indicator flashes indicate a successfully carried out Arm/Disarm command;

B) 1 long beep sound and a single LED indicator flash stands for failed Arm/Disarm command and feedback signal failure;

- EWK2A Panic Alarm feature: if you press EWK2A button while there is no wireless connection, the keyfob will try to send a data event to alarm system every 10 seconds. In case there is no response after 30 minutes of attempts, the EWK2A keyfob will completely ignore the event.

- EWK2A has an advanced setting, which allows to enable button reaction delay time (to prevent unintentional button pressing). The reaction delay time is disabled by default, thus it can be enabled using *ELDES Utility* software. If this feature is enabled, user must enter the preferred reaction delay time value in order to be able to save settings.

- EWK2A has one more feature, which allows to enable keyfob's Buzzer. If this feature is enabled, buzzer will beep once every time EWK2A button is pressed (by default, the feature is disabled). In case when Panic Alarm feature is enabled, **it is recommended to disable** keyfob's Buzzer due to security reasons.

4. INSTALLATION

- Remove the screw located on the back side of EWK2/EWK2A enclosure (see pic. 2).

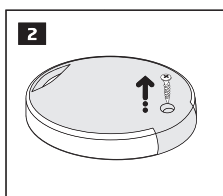

- Open the enclosure (see pic. 3).

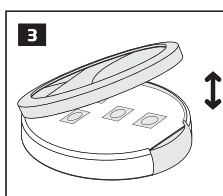

- Once the enclosure is opened, remove the PCB from the EWK2/EWK2A enclosure and flip the PCB so that the back side would be facing up (see pic. 4).

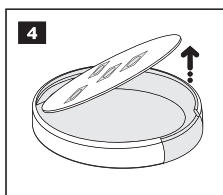

- Insert the CR2032 type battery provided in the EWK2/EWK2A package. Before inserting the battery, ensure that it is positioned correctly (see pic. 5).

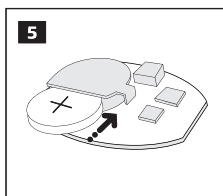

- Insert the PCB back to the enclosure and close it (see pics. 6 and 7).

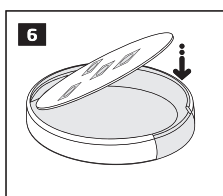

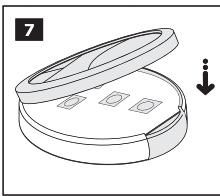

6. Gently screw in the screw (see pic. 8).

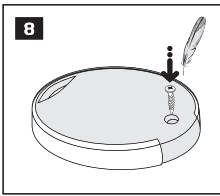

7. Pair the device with the alarm system using *ELDES Utility* software (see an example on Pic. 9). Follow these steps:

- 1) Open *Peripheral Devices* section to see the list of all wireless devices;
- 2) When in *Peripheral Devices* section, press the keyfob button one time (**disarm button on EWK2**) and your keyfob will instantly appear in the list;
- 3) Click **Add to System** button, located next to the unpaired wireless keyfob icon (grey icon);
- 4) Press the keyfob button (**disarm button on EWK2**) several times until the device is successfully paired.

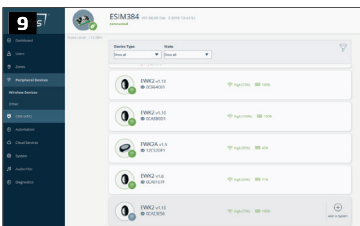

8. If the pairing is successful, the icon next to *EWK2/EWK2A* device will turn **GREEN**.
9. *EWK2/EWK2A* is ready for use.

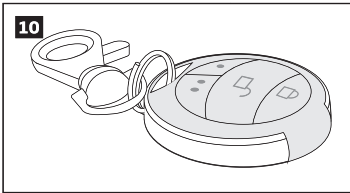

NOTE: If you are unable to pair the wireless device, please restore the parameters of the wireless device to default and try again (see chapter **8. RESTORING DEFAULT PARAMETERS**).

5. PANIC ALARM

By default, *EWK2A* keyfob supports a *Panic Alarm* feature allowing to cause a silent alarm at any time when the keyfob button is pressed.

6. BATTERY REPLACEMENT

1. Open *EWK2/EWK2A* enclosure.
2. Remove the old battery from the battery slot.
3. Position the new battery according to the appropriate battery slot positive terminal indicated.
4. Insert the battery into the battery slot.
5. Battery is replaced.

See **4. INSTALLATION** for more details.

7. SAFETY INSTRUCTIONS

Please read and follow these safety guidelines in order to maintain safety of operators and people around:

- DO NOT use the system where it can be interfere with other devices and cause any potential danger.
- DO NOT use the system with medical devices.
- DO NOT use the system in hazardous environment.
- DO NOT expose the system to high humidity, chemical environment or mechanical impacts.
- DO NOT attempt to personally repair the system.

ATTENTION: Only CR2032 3V battery can be used. Install only new, high quality and unexpired batteries.

ATTENTION: The battery must be removed if the device is unpaired from the system and not in use.



ATTENTION: In order to avoid fire or explosion hazards, special care must be taken when connecting positive and negative battery terminals. Dispose old batteries only into special collection sites. Do not charge, disassemble, heat or incinerate old batteries.

NOTE: The system informs user via *ELDES Security App* as soon as the battery level runs below 5%.

NOTE: The battery status can be monitored in real-time using *ELDES Utility* software.

8. RESTORING DEFAULT PARAMETERS

EWK2

1. Launch *ELDES Utility* software, go to *Peripheral Devices* section, remove previously added *EWK2* keyfob by clicking **Remove** located next to the paired wireless device icon.
2. Press and hold  and  buttons simultaneously.
3. Hold those buttons pressed (approx. for 10 seconds) until LED indicator and the buzzer provide several short flashes and beeps simultaneously.
4. Release the buttons.
5. Default parameters are restored.

EWK2A

1. Launch *ELDES Utility* software, go to *Peripheral Devices* section and remove previously added *EWK2A* device by clicking **Remove** located next to the paired wireless device icon.
2. Press and hold the lower side of the button. 
3. Hold the button pressed (approx. for 10 seconds) until LED indicator and the buzzer provide several short flashes and beeps simultaneously.
4. Release the button.
5. Default parameters are restored.

9. ADDITIONAL INFORMATION

Limited Liability

The buyer must agree that the system will reduce the risk theft, burglary or other dangers but does not provide guarantee against such events. "ELDES, UAB" will not assume any responsibility regarding personal or property, or revenue loss while using the system. "ELDES, UAB" will also assume no liability due to direct or indirect damage or loss, as well as unreceived income when using the system, including cases, when the damages arise due to the above mentioned risks; when due to breakdown or malfunction the user is not informed in a timely manner about a risk which has arisen. In any case, the liability of "ELDES, UAB", as much as it is allowed by the laws in force, shall not exceed the price of acquisition of the product.

Manufacturer Warranty

"ELDES, UAB" warrants this system only to the original purchaser and only in case of defective workmanship and materials under normal use of the system for a period of twenty four (24) months from the date of shipment by the "ELDES, UAB" (Warranty Period). Warranty obligations do not cover expandable materials (power elements and/or batteries), holders and enclosures. The warranty remains valid only if the system is used as intended, following all guidelines outlined in this manual and in accordance with the operating conditions specified. The warranty is void if the system has been exposed to mechanical impact, chemicals, high humidity, fluids, corrosive and hazardous environments or force majeure factors.



The WEEE (Waste Electrical and Electronic Equipment) symbol on this product (see left) means it must not be disposed of in household waste. To prevent possible harm to human health and/or the environment, you must dispose of this product in an approved and environmentally safe recycling facility. For further information contact your system supplier, or your local waste authority.

CE 1383

Copyright © "ELDES, UAB", 2019. All rights reserved

It is strictly forbidden to copy and distribute the information contained in this document or to pass thereof to a third party without an a priori written authorization obtained from "ELDES, UAB". "ELDES, UAB" reserves the right to update or modify this document and/or related products without an a priori warning. "ELDES, UAB" hereby declares that the wireless keyfob *EWK2/EWK2A* is in compliance with the essential requirements and other relevant provisions of the Directive 1999/5/EC. The declaration of conformity is available at www.eldesalarms.com