

1. Introduction

It is a waterproof OSDP reader, and also with Wiegand output, can read 125KHz EM card, HID card & 13.56MHz Mifare cards at the same time.

Features:

- > Waterproof, conforms to IP66
- > OSDP+ Wiegand, AES128 encryption
- > Card Type: 125KHz HID, EM & 13.56MHz Mifare
- > Programmable Wiegand output (by remote control included in the box)
 - EM card: Wiegand 26~44 bits output (default: 26bits)
 - Mifare card: Wiegand 26~44, 56, 58bits output (default: 34bits)
 - HID card: Wiegand 26~37 bits output

Specifications:

Operation Voltage	9-18V DC	
Standby Current	≤50mA	
Frequency	125KHz & 13.56MHz	
Card Type	EM & HID & MIFARE	
Read Range	2~4 cm	
Wiegand Output Format	EM card: Wiegand 26~44 bits output (default: 26bits) Mifare card: Wiegand 26~44, 56, 58bits output (default: 34bits) HID card: Wiegand 26~37 bits output	
Operating Temperature	-40°C~60°C	
Operating Humidity	0% ~ 98% RH	
Color	Black	
Index of Protection	IP66	
Dimension	120x75x20mm(Wide)	120x50x20(Slim)
Net Weight	200g (Wide) / 150g (Slim)	
Shipping Weight	250g (Wide) / 200g (Slim)	

- 01 -

2. Installation

- Drill 2 holes (A, C) on the wall for the screws and one hole (B) for the cable
- Knock the rubber bungs to the holes (A, C)
- Fix the back cover on the wall with 2 screws
- Thread the cable through the cable hole (B)
- Attach the unit to the back cover

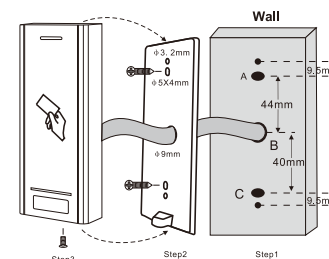

Wiring

Color	Function	Notes
Red	Power +	+12V
Black	GND	Ground
Green	D0	Data 0
White	D1	Data 1
Brown	LED	Green LED Light Control
Yellow	Buzzer	Buzzer Control
Blue	A	RS485A
Gray	B	RS485B

- 02 -

Connection Diagram

Connect with OSDP Controller

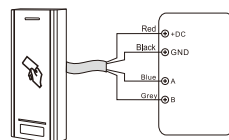

Connect with Wiegand Controller

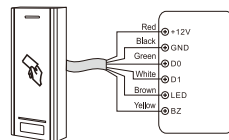

3. Programming

Note: Use the remote control included in the box to do programming

Set Master Code (6 digits)

The Master Code is used to prevent unauthorized access to the system, we highly recommend immediately updating it and recording the New Master Code.

Programming Step	Keystroke Combination
1. Enter Program Mode	*(Master Code) # (factory default: 123456)
2. Update Master Code	0 (New Master Code) # (Repeat New Master Code) #
3. Exit Program Mode	*

- 03 -

Set Wiegand Format for EM Cards

Programming Step	Keystroke Combination
1. Enter Program Mode	*(Master Code) #
2. Set Wiegand Format	1 (26~44) # (Factory default is 26bits)
3. Exit Program Mode	*

Set Wiegand Format for HID Cards

Programming Step	Keystroke Combination
1. Enter Program Mode	*(Master Code) #
2. Output Format Setting	2 0 # (Auto output, factory default) 2 (26-37) #
3. Exit Program Mode	*

Set Wiegand Format for MIFARE Cards

Programming Step	Keystroke Combination
1. Enter Program Mode	*(Master Code) #
2. Output Format Setting	3 0 # (Auto output) 3 (26-44, 56, 58) # (Factory default is 34 bits)
3. Exit Program Mode	*

Baud Rate Settings (Factory default: 9600)

Programming Step	Keystroke Combination
1. Enter Program Mode	*(Master Code) #
Setting values:	6 (4800, 9600, 14400, 19200, 38400, 56000, 57600, 115200, 128000) #
3. Exit Program Mode	*

Note: The baud rate of all readers under the same controller should be set to the same with the controller's baud rate, otherwise the connection will fail.

- 04 -

OSDP Address Settings (Factory default: 0)

Programming Step	Keystroke Combination
1. Enter Program Mode	*(Master Code) #
Setting the address	7 (0-126) #
3. Exit Program Mode	*

Note: The addresses of all readers under the same controller should be set to be different, otherwise the two readers will conflict

Reset to Factory Default (two methods)

Method 1

Programming Step	Keystroke Combination
1. Enter Program Mode	*(Master Code) #
2. Reset to Factory Default	5 0 #
3. Exit Program Mode	*

Method 2 (This way is suitable for users forget the master code):

Power off, connect Yellow wire and GND wire, then power on, wait for 5 seconds, there will be a long beep, means reset to factory default successfully, then disconnect the Yellow wire and GND wire.

4. Indicator light status

Operation Status	Indicator light color	Buzzer
Standby status	OSDP Controller decides	
Correct Card	OSDP Controller decides	beep-
Error Card	OSDP Controller decides	beep-

- 05 -

5. Packing List

Name	Quantity
Reader	1
Remote control	1
Manual	1
Self Tapping Screws	2(Φ4*25mm)
USB Serial Tools	2
Rubber plug	2

- 06 -