

Tuya Wall Lamp Security Wi-Fi Camera

User Manual

Version: Mar, 2023

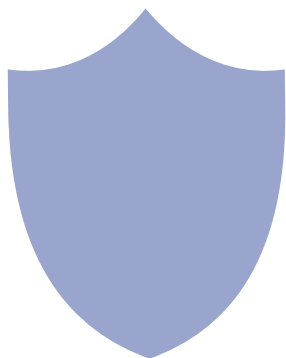

Normal status with bracket

Size:173x60mm



Place device on table

Lamp Status:

When there is a motion, it lights up 1 minute then off. If motion is going on, it keeps on; Once no motion, it goes off.

1

Second, it supports motion detect push alarm notification, cycle recording and work while charging.

Third, it can be used as a daily use indoor wall lamp, which can be lighted on while the PIR detect motions. (When there is a motion, it lights up 1minute then off.)

Usages: Nanny camera, Home/ Shop/ Office/ Warehouse surveillance camera.....

Warning : " illegal use is not allowed! Or, there will be consequences to bear! "

In the box:

- 1 x Camera Unit
- 1 x Micro SD Card Reader
- 1 x USB Cable
- 1 x User Manual
- 1 x Power Adapter
- 1x Universal Bracket

4

Product structure

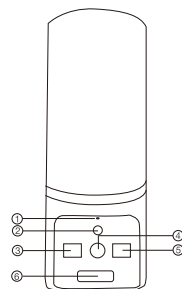

- ① Microphone
- ② Light sensor
- ③ Invisible night vision leds
- ④ Camera
- ⑤ Invisible night vision leds
- ⑥ PIR sensor

5

Quick guide of Wi-Fi camera function:

1.Download & Install Free App <Tuya Smart > from App Store or Google Play;

Tips: Please allow " Tuya Smart " to notification, Bluetooth and location while using the App.

2.Enter App, select your region and register your accounts;

Tips: If a code doesn't arrive, please check the spam folder first.

3.Insert micro SD card --> Turn on back ON/OFF switch (wait around 20seconds till the blue indicator turns from solid to blink); Press Reset key 8 seconds till a dingdong sound(wait around 30 seconds till the blue indicator turns from solid to blink and ready for pairing WiFi);

2

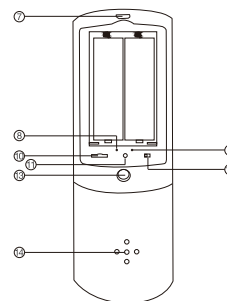

- ⑦ USB charging port
- ⑧ WiFi indicator
- ⑨ Charging indicator
- ⑩ Micro SD card slot
- ⑪ Reset key
- ⑫ ON/OFF switch
- ⑬ Bracket connect part
- ⑭ Camera speaker

6

Step 2: Take off side cover --> Insert micro SD card --> Turn on back ON/OFF switch (wait around 20seconds till the blue indicator turns from solid to blink);

Step 3:Connect device with Wi-Fi

1. Press Reset key 8 seconds till a dingdong sound(wait around 30 seconds till the blue indicator turns from solid to blink and ready for pairing WiFi);

4.Open APP Tuya Smart >> Add devices or Top right "+" >> Camera&Clock >> Smart camera (Wi-Fi) . Tick " Make sure the indicator is flashing quickly, or a prompt tone is heard." >> Next. Click " ← " to select the local router WiFi, then input password. >> Next.

5.Please scan the QR code from 15 to 20cm away. Once you heard a prompt, click "I Heard a Prompt". Device Binding Successful and online now.

Overview:

The Tuya Wall Lamp Security Wi-Fi Camera, is a daily use indoor wall lamp and integrate with a high tech powerful 1080P smart camera inside for daily home / office security use etc.

First, it can be used for watching live streaming video day and night (night vision around 5 meters), or taking photo and video by APP in smart-phone remotely after WiFi connected;

3

Reset steps:

1.Turn on device wait around 20seconds till the blue indicator turns from solid to blink.

2.Long press reset key around 8 seconds till a "dingdong" sound, wait around 30 seconds till the blue indicator turns from solid to blink. The reset is done.

Wi-Fi indicator tips:

Blink blue when pairing with WiFi;
Solid blue when WiFi paired; (Can be turned off in App, Setting>Basic Function Settings>Status Indicator)

Charging indicator tips:

Solid red when charging, and off when fully charged.

7

Wi-Fi Camera Connection Setting

Step1: "Tuya Smart" App

1. Scan below QR code or search and download free APP named < Tuya Smart > in Apple APP store, Google play or Electronic market, and install it;



App: Tuya Smart

8

2.Open Tuya Smart App, Click "Sign Up"and "Agree" the Privacy Policy to continue. Select your current region and register with email / mobile number, or third-party account like Facebook, Google or IOS account. (Tips: If a code doesn't arrive, please check the spam folder first.)

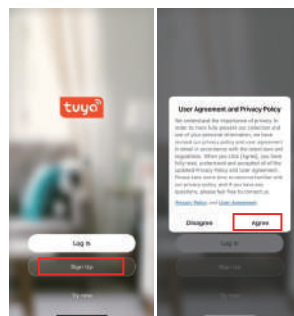

9

Step 3:Connect device with Wi-Fi

1. Press Reset key 8 seconds till a dingdong sound(wait around 30 seconds till the blue indicator turns from solid to blink and ready for pairing WiFi);

10

2. Open APP Tuya Smart >> Add devices or Top right "+" >> Camera&Clock >> Smart camera (Wi-Fi) . Tick " Make sure the indicator is flashing quickly, or a prompt tone is heard." >> Next.

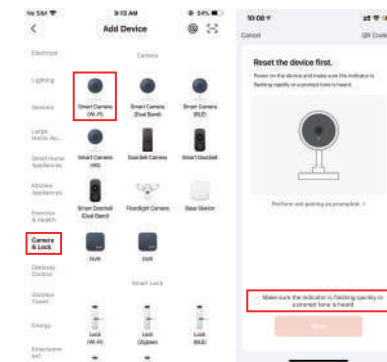

11

3. Click “↔” to select the local router WiFi, then input password. >> Next.

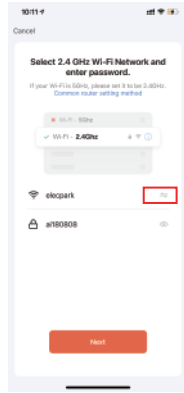

12

4. Please scan the QR code from 15 to 20cm away. Once you heard a prompt, click "I Heard a Prompt". Device Binding Successful and online now.

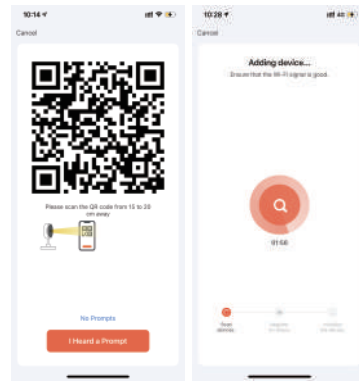

13

APP Introduction

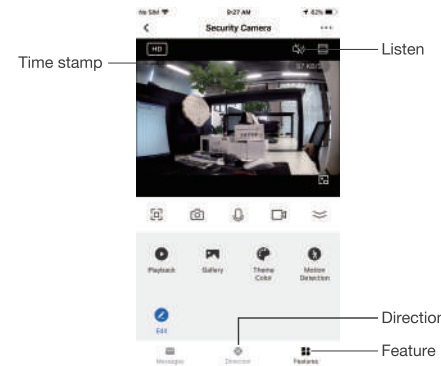

Features: Main functions of the camera
 Direction: Control the PAN rotate of camera lens and laser tease

14



15

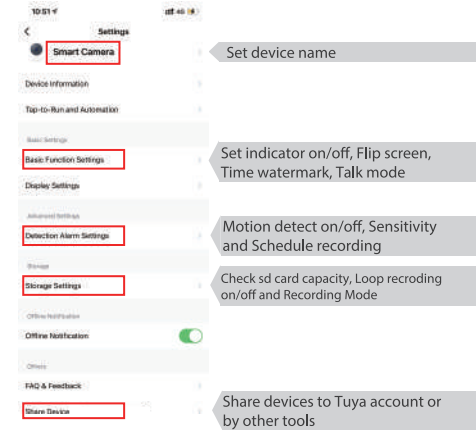

16

Specification

Resolution	2 Mega CMOS
Video pixel	1920*1080
Frames	Max 25fps
Compressed format	H.264
View angle	145 Degree
Type of memory card	TF card=Class 4/10 and HC marked
Maximum capacity of memory card	128 GB
Mobile phone operation system	Android/iOS
Compatible router	2.4G and Mobile hotspot
Two way talking	Yes
Lamp power consumption	150mA
Power consumption	250 mAh
Power consumption with night vision	450 mAh
Charging current	420 mA/h
Battery	Default 1 piece, 2500mA
Battery life	Around 4 / 8 hours
Charging time	Around 6hours
Power adapter	5V2A

17

FAQ

- Q: Why videos recorded in SD card can't be read by PC?
 A: 1) This is Tuya patent to protect recorded files by encryption format.
 A: 2) If need to check videos in card, enter App > playback: Select video date, record or screenshot needed moments. Then check at App album.
- Q: What does the device do when WiFi off?
 A: Keep searching WiFi signal all the time; If WiFi on, it will be connected to WiFi automatically.
- Q: Any other way to connect device with Wi-Fi?
 A: 1) Press Reset key 8 seconds till a dingdong sound(wait around 30 seconds till the blue indicator turns from solid to blink and ready for pairing WiFi);
 4. Q: Where to get more info about Tuya Smart App?
 A: Pls visit developer.tuya.com , then Documentation > App Development > All-in-One App > Smart Life > User Guide

18

A: 2) Open APP Tuya Smart >> Add devices or Top right "+" >> Security & Video surveillance >> Smart camera (Wi-Fi) . Click top right "↔" to select AP mode. Tick "Power on the device and make sure the indicator is flashing rapidly or a prompt tone." >> Next.

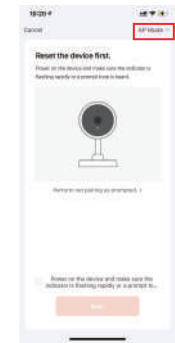

19

A: 3) Click “↔” to select the local router WiFi, then input password. >> Next.

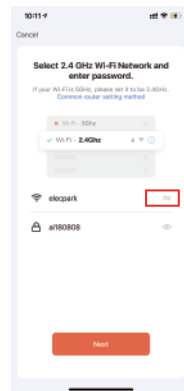

20

A: 4) Connect your mobile phone to the device's hotspot named "SmartLife-xxxx, or SL-xxxx". Click "Confirm hotspot connection, next" Then device is being added, and online soon.

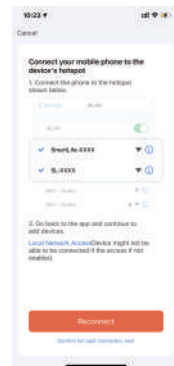

21



The end!