

## Quick Installation Guide

For product or function details, please go to [www.tendacn.com](http://www.tendacn.com) to download user guide.

AC1200 Smart Dual-Band WiFi Router  
Model: AC7

### Package contents

- Wireless router \* 1
- Power adapter \* 1
- Ethernet cable \* 1
- Quick installation guide \* 1



If any item is incorrect, missing, or damaged, please keep the original package and contact the local reseller or distributor immediately.

## 1 Install the router

If you want to replace your original router connected to the internet with a PPPoE user name and password, start from **Step 1**. Otherwise, start from **Step 2**.

### Step 1: Migrate your PPPoE user name and password from your original router

1. Power on your original and new routers.
2. Connect the WAN port of the original router to port 1, 2 or 3/IPTV of the new router using an Ethernet cable.
3. Wait about 6 seconds (When the WAN, LAN indicators of the new router turn solid on after blinking fast, your migration is successful).
4. Remove the original router.

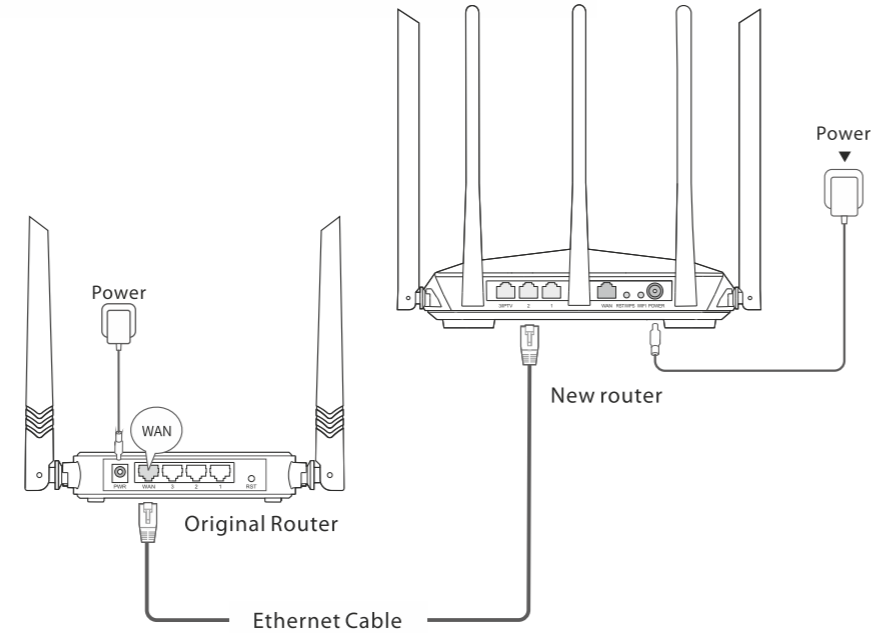

### Step 2: Connect to the internet

1. Power off your modem, and remove its battery (if any).
2. Connect the WAN port of the new router to the LAN port of your modem using an Ethernet cable.
3. Reinstall your modem's battery, then power on your modem and the new router.

**Tip:** If you access the internet through Ethernet jack, connect WAN port of the router to the Ethernet jack using an Ethernet cable.

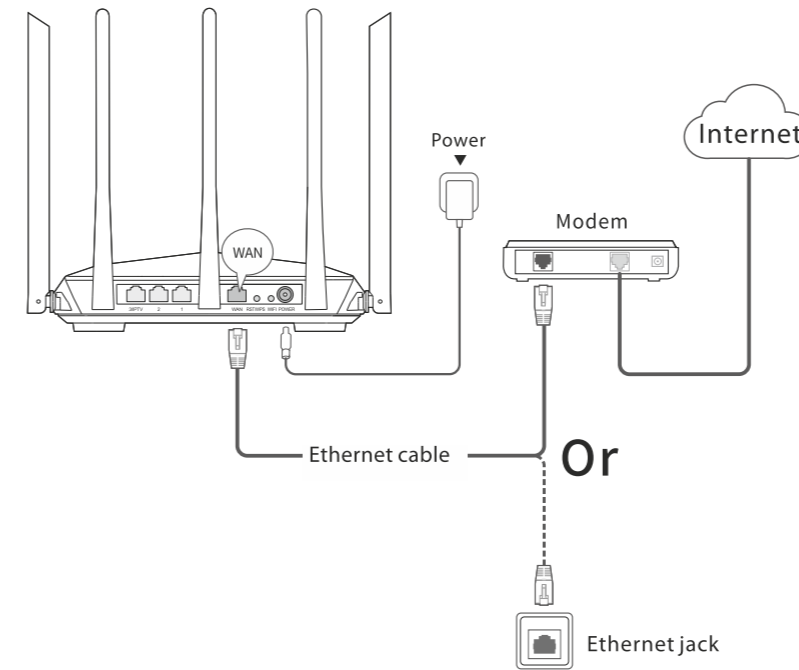

## 2 Connect devices

Connect your wireless devices to the router using the SSID and WiFi password labeled on the bottom/front of the router.

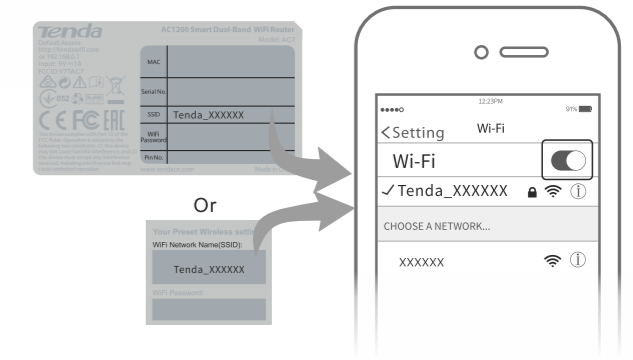

Connect your wired devices to ports 1, 2 or 3/IPTV of the router using Ethernet cables. The LAN indicator fast blinks twice.

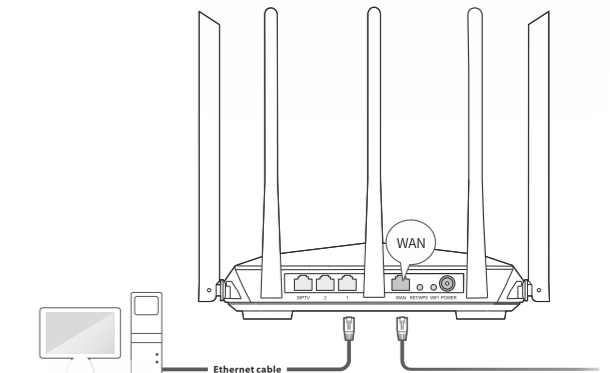

## 3 Set up you router

1. Start a web browser on a device that has connected to the router. Enter **tendawifi.com** in the address bar, and press **Enter**.
2. Click **Start**. (If the following page does not appear, refer to **Q1** in the **FAQ**.)

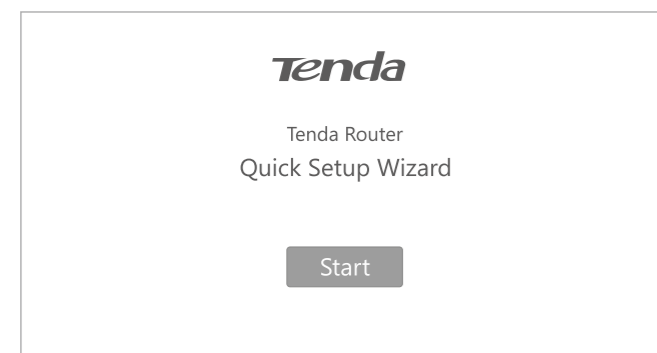

3. Confirm or set the related parameters. Then click **Next**. (PPPoE is used as an example here.)

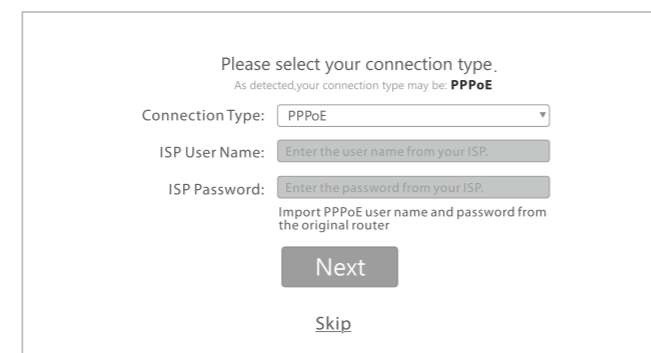

4. Set your WiFi name (SSID), WiFi password and login password. Then click **Next**.

**Note:** The WiFi password is used to connect to the WiFi network of the router, and the login password is used to log in to the web UI to manage the router.



Reconnect your wireless devices to the router's WiFi network using the WiFi names and the WiFi password you set. The wired devices can access the internet directly if they have connected to port 1, 2 or 3/IPTV.

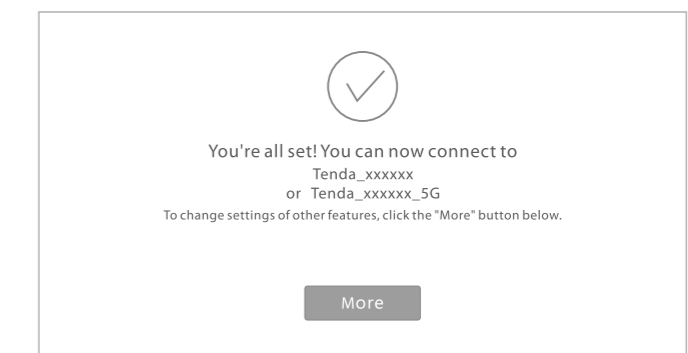

**Tip:** If the internet is still inaccessible after the configuration, please refer to **Q2** in the **FAQ**.

LED indicator	Status	Description
SYS	Solid on	<ul style="list-style-type: none"> <li>The router is starting.</li> <li>If the indicator is still solid on after your router completes startup, it indicates that the system is faulty.</li> </ul>
	Slow blinking	The router is working properly.
WAN	Solid on	The WAN port is connected properly.
	Fast blinking	Data is being transmitted over the WAN port.
	Off	The WAN port is disconnected or connected improperly.
LAN	Solid on	Port 1, 2 or 3/IPTV is connected properly.
	Fast blinking twice	A new device is connected to port 1, 2 or 3/IPTV.
	Off	None of ports 1, 2 and 3/IPTV is connected or connected properly.
WiFi	Solid on	At least the 2.4 GHz or 5 GHz WiFi network is enabled.
	Fast blinking	Data is being transmitted wirelessly.
	Slow blinking	The router is performing WPS negotiation.
	Off	The WiFi network is disabled.

Port/Button	Description
POWER	Used to connect to the power adapter included in the package.
WIFI	Press the button once to enable/disable the WiFi network of the router.
RST/WPS	Used to start the WPS negotiation process, or to reset the router. <ul style="list-style-type: none"> <li><b>WPS:</b> Press the button of the router, and enable the WPS function of another device within 2 minutes to establish a WPS connection.</li> <li><b>Reset:</b> When the <b>SYS</b> indicator blinks, hold the button down for about 8 seconds. The router is reset successfully when all the LED indicators blink once.</li> </ul>
WAN	Used to connect the router to the internet.
1/2	They are LAN ports used to connect to wired devices such as computers or switches.
3/IPTV	<ul style="list-style-type: none"> <li>It is a default LAN port.</li> <li>But if the IPTV function of the router is enabled, it serves only as an IPTV port used to connect to a set-top box.</li> </ul>

## FAQ

### Q1: I cannot log in to the web UI of the router after entering tendawifi.com, what should I do?

A1: Try the following solutions and log in again:

- Ensure that your Ethernet cable with internet connectivity is plugged into the WAN port of the router rather than a LAN port.
- Ensure that your wireless device is connected to the router's SSID.
- Ensure that your wired device is connected properly to port 1, 2 or 3/IPTV of the router by Ethernet cable. The device is also set to **Obtain an IP address automatically** and **Obtain DNS server address automatically**.
- Ensure that **tendawifi.com** is entered correctly, or try logging by **192.168.0.1**.
- Replace the web browser.
- Reset the router and log in again.

### Q2: I cannot access the internet after the configuration, what should I do?

A2: Log in to the web UI of the router, and check your router's connection status on the **Internet Status** page.

- If your router is connected to the internet successfully as the figure shown below, try the following solutions:

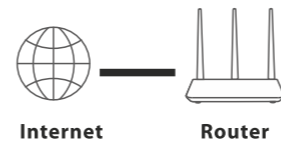

Connect your wireless devices to the WiFi network of the router using the new WiFi name and password you set.

- If **Connection failed** appears on the page:
  - Click **Internet Settings** on the web UI to check whether the connection type and parameters you entered are correct.

Connection type	Information provided by your ISP
PPPoE	ISP user name and ISP password
Dynamic IP address	None
Static IP address	IP address, subnet mask, gateway, DNS server and other parameters

- Connect the Ethernet cable with internet connectivity to your computer.
- ◆ If your computer cannot access the internet, consult your ISP.
- ◆ Otherwise, reconnect the Ethernet cable with internet connectivity to your router, reset your router and configure it again.

### Q3: How to reset the router?

A3: When the **SYS** indicator blinks, hold down the **RST/WPS** button for about 8 seconds. The router is reset successfully when all the LED indicators blink once.



### CE Mark Warning

This is a Class B product. In a domestic environment, this product may cause radio interference, in which case the user may be required to take adequate measures.

Operations in the 5.15-5.25GHz band are restricted to indoor use only. This equipment should be installed and operated with minimum distance 20cm between the radiator & your body.

The mains plug is used as disconnect device, the disconnect device shall remain readily operable.

**NOTE:** (1) The manufacturer is not responsible for any radio or TV interference caused by unauthorized modifications to this equipment. (2) To avoid unnecessary radiation interference, it is recommended to use a shielded RJ45 cable.

### Declaration of Conformity

Hereby, SHENZHEN TENDA TECHNOLOGY CO., LTD. declares that the radio equipment type AC7 is in compliance with Directive 2014/53/EU.

The full text of the EU declaration of conformity is available at the following internet address:

<http://www.tendacn.com/en/service/download-cata-101.html>

Operate Frequency:

2.4G: EU / 2400-2483.5 MHz (CH1-CH13)

5G: EU / 5150-5250 MHz (CH36-CH48)

EIRP Power (Max.):

2.4 GHz: 19.86 dBm

5 GHz: 22.96 dBm

Software Version: V15.03.06.XX



### Caution:

Adapter Model: BN052-A09009E/BN052-A09009B

Manufacture: SHENZHEN HEWEISHUN NETWORK TECHNOLOGY CO., LTD.

Input: 100 - 240 V AC, 50/60 Hz, 0.3 A

Output: 9 V ≡ 1.0 A

≡ : DC Voltage



### FCC Statement

This equipment has been tested and found to comply with the limits for a Class B digital device, pursuant to Part 15 of the FCC Rules. These limits are designed to provide reasonable protection against harmful interference in a residential installation. This equipment generates, uses and can radiate radio frequency energy and, if not installed and used in accordance with the instructions, may cause harmful interference to radio communications. However, there is no guarantee that interference will not occur in a particular installation. If this equipment does cause harmful interference to radio or television reception, which can be determined by turning the equipment off and on, the user is encouraged to try to correct the interference by one or more of the following measures:

— Reorient or relocate the receiving antenna.

— Increase the separation between the equipment and receiver.

— Connect the equipment into an outlet on a circuit different from that to which the receiver is connected.

— Consult the dealer or an experienced radio/TV technician for help.

The device is for indoor usage only.

This device complies with Part 15 of the FCC Rules. Operation is subject to the following two conditions: (1) this device may not cause harmful interference, and (2) this device must accept any interference received, including interference that may cause undesired operation.

### Radiation Exposure Statement

This device complies with FCC radiation exposure limits set forth for an uncontrolled environment and it also complies with Part 15 of the FCC RF Rules.

This equipment should be installed and operated with minimum distance 20cm between the radiator & your body.

### Caution:

Any changes or modifications not expressly approved by the party responsible for compliance could void the user's authority to operate this equipment.

This transmitter must not be co-located or operating in conjunction with any other antenna or transmitter.

**NOTE:** (1) The manufacturer is not responsible for any radio or TV interference caused by unauthorized modifications to this equipment. (2) To avoid unnecessary radiation interference, it is recommended to use a shielded RJ45 cable.

	BE	BG	CZ	DK	DE	EE	IE	EL	ES	FR	HR	IT	CY	LV
	LT	LU	HU	MT	NL	AT	PL	PT	RO	SI	SK	FI	SE	UK

Operating Temperature: 0 °C - 40 °C

Operating Humidity: (10% - 90%) RH, non-condensing



### RECYCLING

This product bears the selective sorting symbol for Waste electrical and electronic equipment (WEEE). This means that this product must be handled pursuant to European directive 2012/19/EU in order to be recycled or dismantled to minimize its impact on the environment.

User has the choice to give his product to a competent recycling organization or to the retailer when he buys new electrical or electronic equipment.



**Copyright** © 2018 Shenzhen Tenda Technology Co., Ltd. All rights reserved. Tenda is a registered trademark legally held by Shenzhen Tenda Technology Co., Ltd. Other brand and product names mentioned herein are trademarks or registered trademarks of their respective holders. Specifications are subject to change without notice.

## Technical Support

Shenzhen Tenda Technology Co., Ltd.  
6-8 Floor, Tower E3, NO.1001, Zhongshanyuan Road, Nanshan District, Shenzhen, China. 518052  
USA hotline: 1-800-570-5892  
Canada hotline: 1-888-998-8966  
Website: <http://www.tendaus.com>  
Email: [support.usa@tenda.com.cn](mailto:support.usa@tenda.com.cn)  
Hong Kong Hotline: 00852-81931998  
Website: <http://www.tendacn.com>  
E-mail: [support@tenda.com.cn](mailto:support@tenda.com.cn)