



Install Guide

300Mbps High Gain Wireless USB Adapter
Go to www.tendacn.com for more info about this product.

English

1 Install wireless USB adapter
Insert the wireless USB adapter into the USB port of your PC.

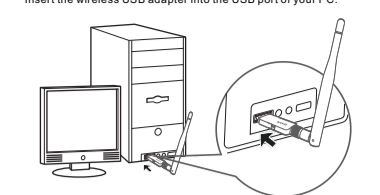

TIP:
The wireless USB adapter is compatible with Windows XP/Vista/7/8/10, Linux, and Mac OS.

2 Install network adapter program
a. Insert the CD included in your PC's CD drive.

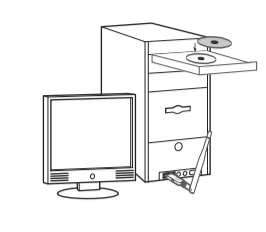

TIP:
When using the CD to install the program, it can connect to WiFi with the wireless USB adapter directly.

b. Open the CD file and double click **Setup.exe** to run the adapter program.

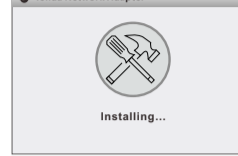

Check "Accept the agreement" and then click **Install Now**.
Note that the installation directory cannot include Chinese characters, or installation may fail.



Click **Done** to finish setup.

3 Connect to WiFi
After installing the wireless USB adapter and Tenda Network Adapter program successfully, you can connect to a wireless network.

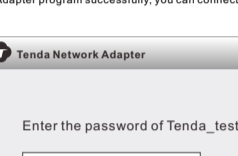
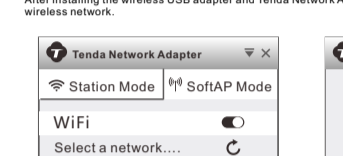

1 Find your WiFi and click it. 2 Enter the WiFi password and click **OK**.

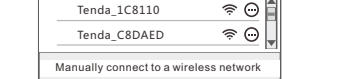
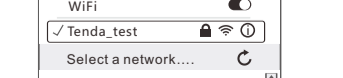
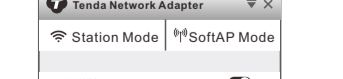
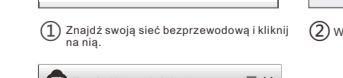
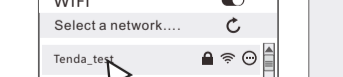
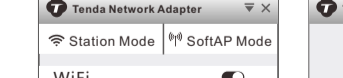
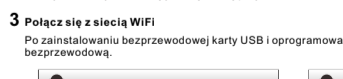
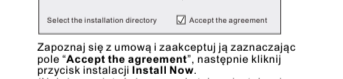
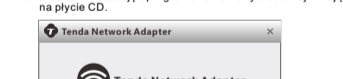
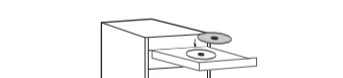
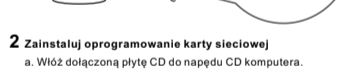
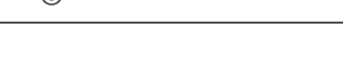
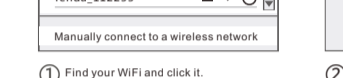

Español

1 Instala el USB Adaptador inalámbrico
Inserta el USB Adaptador inalámbrico al puerto de USB de su computador.



TIP:
Este USB Adaptador inalámbrico es compatible con Windows XP/Vista/7/8/10, Linux, y Mac OS.

2 Instala el programa de Adaptador de red de Tenda
a. Inserta el CD incluido al disco de disco de su ordenador.

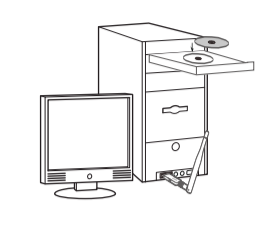

TIP:
Cuando se utiliza el CD para instalar el programa, se puede conectar con WiFi directamente al adaptador USB inalámbrico.

b. Abra el archivo del CD y de doble clic en **Setup.exe** para activar el programa.



Compruebe "Aceptar el acuerdo" y luego haga clic en **Instalar Ahora**.
Nota que el directorio de instalación no puede incluir caracteres chinos, o la instalación no se completará.



Haga clic en **Done** para completar la configuración.

3 Conectar a WiFi
Después de instalar con éxito el USB Adaptador inalámbrico y el programa de Adaptador de red de Tenda, usted puede conectar a red inalámbrica.

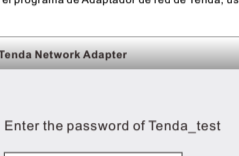
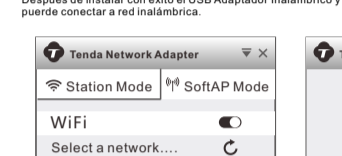

1 Encuentre su WiFi y clic en él. 2 Ponga la contraseña de WiFi y clic **OK**.

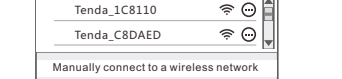
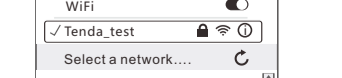
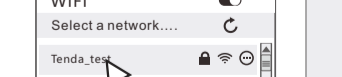
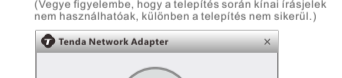
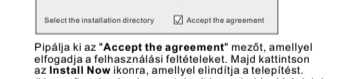
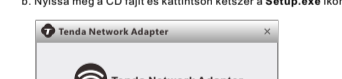
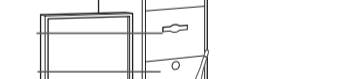
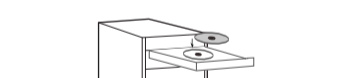
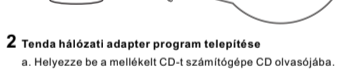

Türkçe

1 Kablosuz USB Adaptörünün Kurulumu
Kablosuz USB adaptörünü bilgisayarınızın USB bağlantı noktasına takın.

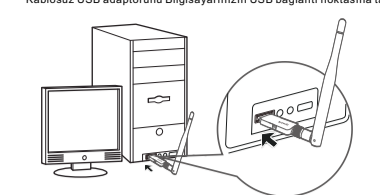

IPUCU:
Kablosuz USB adaptörü, Windows XP/Vista/7/8/10, Linux ve Mac OS ile uyumlu çalışmaktadır.

2 Tenda Ağ Bağlantısını Programın Kurulumu
a. Paket içerisindeki CD'yi bilgisayarınızın CD sürücüsüne takın.

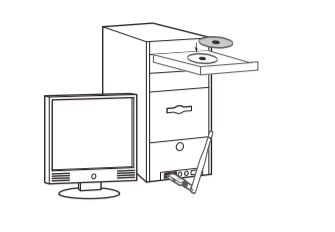

IPUCU:
Windows 10 için, program kurulumunu, Windows 10 Kablosuz USB Adaptörüne bağlanan Kablosuz Ağ bağlantısı gerçekleştirin.

b. CD dosyasını açın ve bağlantı programı çalıştırmak için **Setup.exe**'ye çift tıklayın.

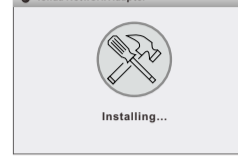

"Accept the agreement" kutucuğunu işaretleyin ve **Install Now** butonuna tıklayın.
Not: Kurulum dizini, Çince karakterler içeremez veya kurulum bilgisayarsızlığı içeremez.



Kurulum tamamlandı. Bu işlem için bir kaç dakika sürecektir. Lütfen sabırlı olun.

Kurulumu tamamlamak için **Done** butonuna tıklayın.

3 Kablosuz Ağ Bağlantısı
Kablosuz USB adaptörünü ve Tenda Ağ bağlantısı programını başarıyla kurduktan sonra, herhangi bir kablosuz ağ bağlantısına girin.

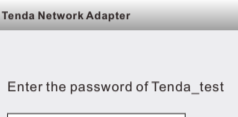
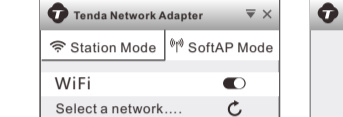

1 Kablosuz Ağ'ınızı bulun ve üzerine tıklayın. 2 Kablosuz Ağ şifresini girin ve **OK** butonuna tıklayın.

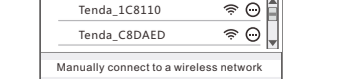
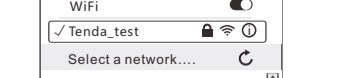
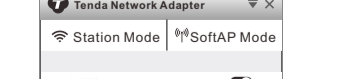
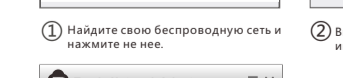
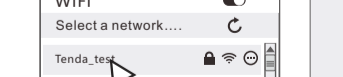
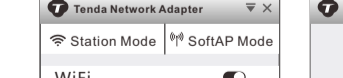
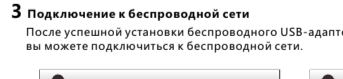
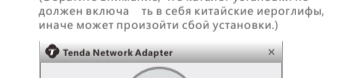
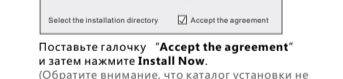
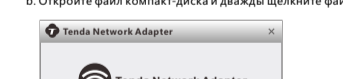
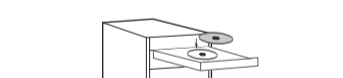
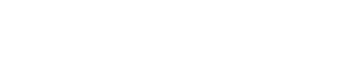
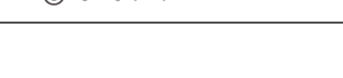
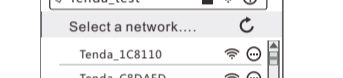
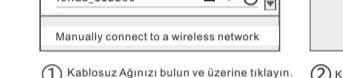

Português

1 Instalação de adaptador USB sem fio
Insira o adaptador USB sem fio na porta USB do seu computador.



DICA:
O adaptador USB sem fio é compatível com Windows XP/Vista/7/8/10, Linux e Mac OS.

2 Instalação do programa do adaptador de rede Tenda
a. Insira o CD (incluído) no drive do seu computador.

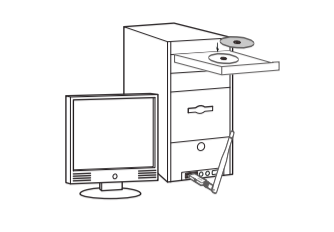

DICA:
O Windows 10 não requer a instalação do programa. Ele pode se conectar ao Wi-Fi diretamente com o adaptador USB wireless.

b. Abra o arquivo do CD e dê um duplo clique em **Setup.exe** para executar o programa do adaptador.

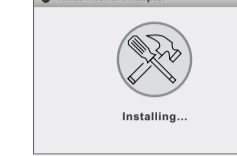

Marque a caixa "Accept the agreement" e clique em **Install Now**.
Nota: O diretório de instalação não pode incluir caracteres chineses, ou a instalação não será concluída.



Clique em **Done** para finalizar a configuração.

3 Conectar a Wi-Fi
Após a instalação bem sucedida do adaptador USB sem fio e do programa do adaptador de rede Tenda você pode se conectar a uma rede sem fio.

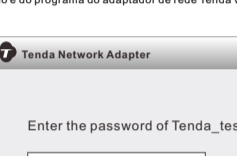

1 Encontre sua rede Wi-Fi e clique nela. 2 Insira a senha da Wi-Fi e clique em **OK**.

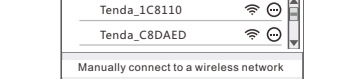
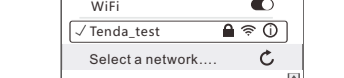
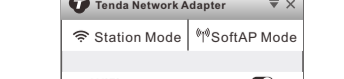
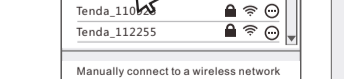
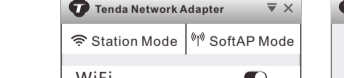
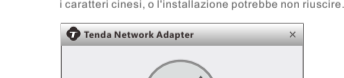
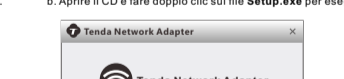
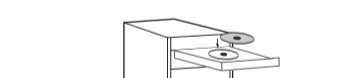
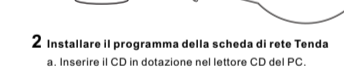
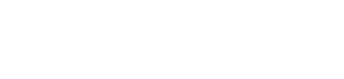
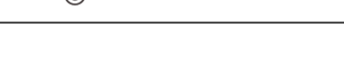
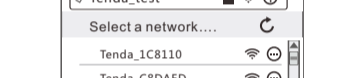
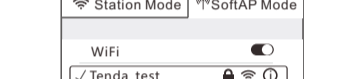

Deutsch

1 WLAN-USB-Adapter installieren
Schließen Sie den WLAN-USB-Adapter an einem USB-Port Ihres PCs an.



HINWEIS:
Der WLAN-USB-Adapter ist kompatibel mit Windows XP/Vista/7/8/10, Linux und Mac OS.

2 Tenda Netzwerkadapter-Software installieren
a. Legen Sie die mitgelieferte CD im Laufwerk Ihres PCs ein.

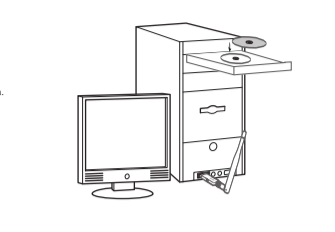

HINWEIS:
Für Windows 10 muss die Software nicht installiert werden, es erfolgt eine direkte Verbindung mit dem WLAN über den WLAN-USB-Adapter.

b. Doppelklicken Sie auf **Setup.exe** auf der CD und lassen Sie die Adapter-Software ablaufen.

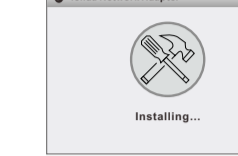

Markieren Sie "Accept the agreement" ab und klicken Sie auf **Install Now**.
Bitte beachten Sie: Das das Installationsverzeichnis keine chinesischen Schriftzeichen enthalten darf, eine Installation ist damit nicht möglich.



Klicken Sie auf **Done**, um die Installation zu beenden.

3 Mit WLAN verbinden
Nach der erfolgreichen Installation des WLAN-USB-Adapters und der Tenda Netzwerkadapter-Software können Sie sich mit einem WLAN-Netzwerk verbinden.

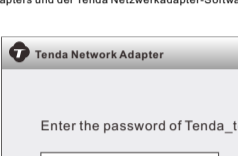

1 Suchen Sie Ihr WLAN-Netzwerk und klicken Sie darauf. 2 Geben Sie das WLAN-Passwort ein und klicken Sie auf **OK**.

