

Wide Angle Outdoor Detector

**QX Infinity series**

**BATTERY OPERATED MODEL**

QXI-R: Standard Battery Operated Model

QXI-RDT-X5: +Microwave detection (10.525 GHz)

QXI-RDT-X8: +Microwave detection (10.587 GHz)

QXI-RDT-X9: +Microwave detection ( 9.425 GHz)

**1 Introduction**



PDF download and additional information with **multilanguage**, available in;

<http://navi.optex.net/manual/50337>

- FR** Le téléchargement PDF et des informations supplémentaires multilingues sont disponibles dans l'URL indiquée.
- DE** PDF-Download und zusätzliche Informationen in mehreren Sprachen finden Sie unter der angezeigten URL.
- IT** Download PDF e ulteriori informazioni con multilingua sono disponibili nell'URL mostrato.
- ES** La descarga de PDF y la información adicional en varios idiomas están disponibles en la URL que se muestra.
- PT** PDF download e informações adicionais com multilanguage estão disponíveis no URL mostrado.
- NL** PDF-downloads en aanvullende informatie met meertalige zijn beschikbaar in de getoonde URL.

**2 Manufacturer's statement**

**Warning**

**Prohibited**

**Recommended**

**Caution**

**Mounting height**

**Multi Level** 2.2 m (7'3") to 2.7 m (8'11")

**Pet Alley** 0.8 m (2'7") to 1.2 m (4')

**Tilt**

Replace the transmitter battery with the dummy battery (included) for battery sharing.

**3 Installation**

**Do not touch the parts with this sign.**

**Maximum Transmitter Size (mm)**

**MW Sensitivity**

L H default

**Connectors**

Main unit side	Transmitter side
Power <input type="checkbox"/> Red	<input type="checkbox"/> Red
Alarm <input type="checkbox"/> Black	<input type="checkbox"/> Black
<input type="checkbox"/> White	<input type="checkbox"/> White
<input type="checkbox"/> Yellow	<input type="checkbox"/> Yellow
Trouble <input type="checkbox"/> Green	<input type="checkbox"/> Green
<input type="checkbox"/> Blue	<input type="checkbox"/> Blue

**<Accessories>**

- Dummy battery and Connector for ALARM
- Connector for TROUBLE
- Mounting screw (4 x 20 mm) x 3
- Fixing screw for the Main unit (3 x 12 mm) x 1
- Area masking strips

**LED**

Function	Seconds
[1] Warm-up	60
[2] Alarm	2
[3] Walk test end	5

**Battery Life**

Model	Battery saving timer (DIP SW No.5)	
	120	5
QXI-R	6	5
QXI-RDT	4	3

Unit: estimated years

**How to open the cover**

[1] Unlock the cover using a screwdriver (-).

[2] Lift the cover up.

**Wall tamper option**

**Battery sharing**

[1] Install dummy battery in transmitter

[2] CR123A

**<Options>**

- CA-1W(W) Bracket for wall mount
- CA-2C(W) Bracket for ceiling mount

## 4 Settings

### 4-1. Detection area

**Multi Level** **Top view**

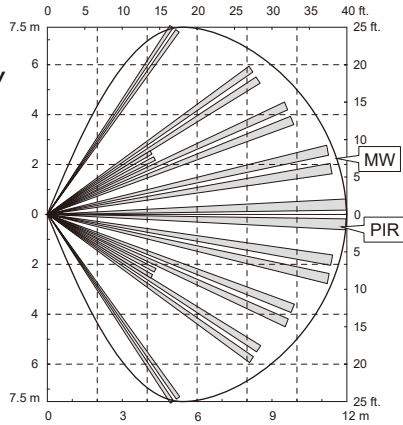

**Side view**

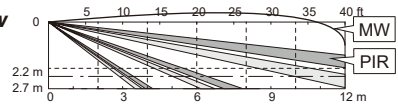

**Pet Alley** **Side view**

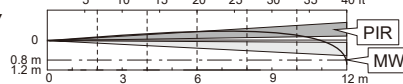

- [1] Loosen the lock screw.
- [2] Slide the Main unit down.
- [3] Rise the mirror up to the fixing position.
- [4] Tighten the lock screw as before.

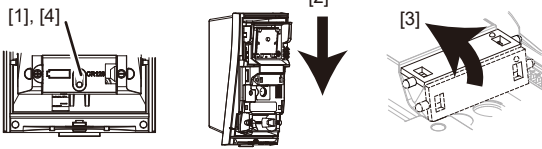

### 4-2. DIP switch settings

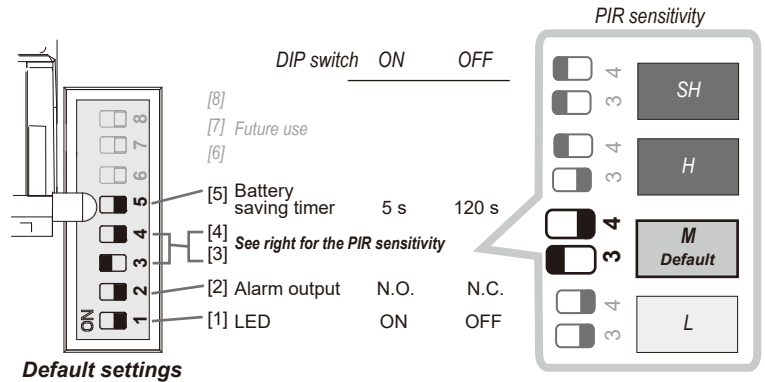

**Default settings**

### 4-3. Walk test

[1] Close cover

[2] Walk test (3 minutes)

[3] Walk test ends

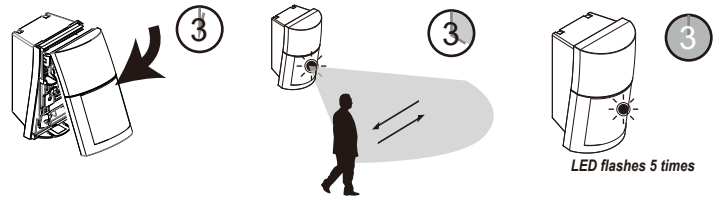

**NOTE**

- With the cover open, the tamper activates. This enables the LED function, regardless of DIP switch [1] setting.
- When the cover is closed, the Walk test timer starts and automatically returns to the normal mode after 3 minutes.
- If the unit is powered up with the cover closed, it will not enter walk test mode. Open and close the cover once to activate the walk test timer.

## 5 Specifications

### 5-1. Specifications

Model	QXI-R	QXI-RDT
Detection method	Passive infrared	Passive infrared & Microwave
PIR coverage	12.0 m (40') 120° wide	
PIR zones	Multi level: 40 zones Pet alley: 18 zones	
Detectable speed	0.3 to 2.0 m/s (1' to 67"/s)	
Sensitivity	2.0°C (3.6°F) at 0.6 m/s	
Pet alley	Remove lower area detection to avoid small animals.	
Power source	CR123A (3 V DC) *Not included.	
Current draw	9 µA stand-by 11 mA max. at 3 V DC	16 µA stand-by 11 mA max. at 3 V DC
Alarm period	2.0 ± 0.5 s	
Warm-up period	Approx. 60 s (LED blinks)	
Alarm output	N.C/N.O. switchable solidstate switch, 3 V DC 0.01 A max.	
Trouble output (with tamper)	N.C/N.O. switchable solidstate switch, 3 V DC 0.01 A max.	
LED indicator	[1] Warm-up	[2] Alarm [3] Walk test end
Operation temperature	-40°C to +60°C (-40°F to +140°F)	-40°C to +45°C (-40°F to +113°F)
Environment humidity	95% max.	
Internation protection	IP 54	
Mounting	Wall (Outdoor, Indoor)	
Mounting height	Multi level: 2.2 to 2.7 m (7' 3" to 8' 11") Pet alley: 0.8 to 1.2 m (2' 7" to 4')	
Weight	215 g (7.58 oz)	230 g (8.11 oz)
Accessories	[1] Dummy battery and connector for ALARM [2] Connector for TROUBLE [3] Mounting screw (4 x 12 mm) x 3 [4] Lock screw (3 x 12 mm) x 1 [5] Area masking strips	

- Specifications and designs are subject to change without prior notice.
- These units are designed to detect an intruder and activate an alarm control panel. Being only a part of a complete system, we cannot accept responsibility for any damages or other consequences resulting from an intrusion.

### 5-2. Dimensions

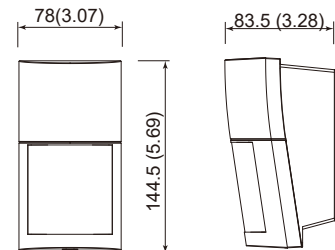

#### EU contact information

##### Manufacturer:

OPTEX CO., LTD.  
5-8-12 Ogoto, Otsu, Shiga, 520-0101 JAPAN

##### Authorized representative in Europe:

OPTEX (EUROPE) LTD./EMEA HEADQUARTERS  
Unit 13, Cordwallis Park, Clivemont Road,  
Maidenhead, Berkshire, SL6 7BU U.K.



OPTEX INC./AMERICAS HQ (U.S.)  
www.optexamerica.com

OPTEX (EUROPE) LTD./EMEA HQ (U.K.)  
www.optex-europe.com

OPTEX TECHNOLOGIES B.V.  
(The Netherlands)  
www.optex.eu

OPTEX CO., LTD. (JAPAN)  
www.optex.net

OPTEX SECURITY SAS (France)  
www.optex-europe.com/fr

OPTEX SECURITY Sp.z o.o. (Poland)  
www.optex.com.pl

OPTEX PINNACLE INDIA,  
PVT., LTD. (India)  
www.optexpinnacle.com

OPTEX KOREA CO., LTD. (Korea)  
www.optexkorea.com

OPTEX (DONGGUAN) CO., LTD.  
SHANGHAI OFFICE (China)  
www.optexchina.com

OPTEX (Thailand) CO., LTD. (Thailand)  
www.optex.co.th

Copyright (C) 2019 OPTEX CO., LTD.