

**Get to Know the Devices**

**LED Indicators**

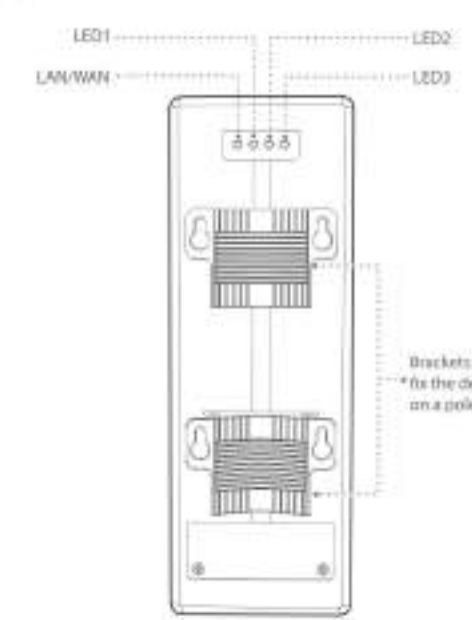

LED Indicator	Status	Description
LAN/WAN	Solid on	The power is supplied to the device properly, and no data is being transmitted.
	Blinking	The port is transmitting or receiving data.
	Off	No power is supplied to the device.
LED1, LED2, LED3 (Signal Strength LED)	Solid on	The device is working in AP, Repeater, P2MP or Router mode, and connected to wireless clients. If the device is automatically connected to the other one, it is set to AP mode. LED1 and LED2 are solid on, and LED3 is off: Good signal. LED1 is solid on, and LED2 and LED3 are off: Weak signal. Please adjust the direction or location of the two devices.
	Blinking	The device is working in Client, Universal Repeater or WISP mode, and connected to a remote AP. If the device is automatically connected to the other one, it is set to Client mode.
	Off	The device is not connected to a wireless client or a remote AP.

**Ports & Button**

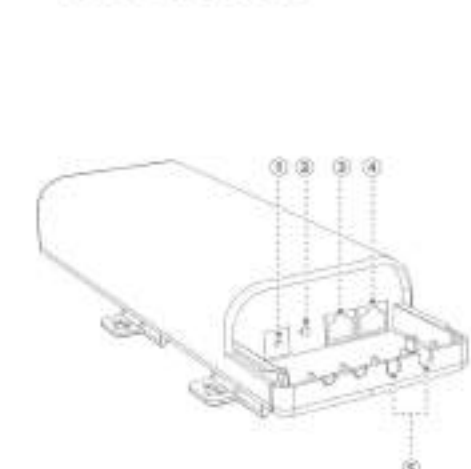

ID	Port/Button	Description
1	GND	Grounding pillar. Use the included grounding screw and cable to connect the device's grounding pillar to a grounding terminal of building to resist ESD and lightning damage to the device.
2	RST	Reset Button. After the device is powered on for 1 minute, hold down this button for about 8 seconds. When all the LED indicators on the device light up, the device restores to the factory settings.
3	LAN	10/100 Mbps automatic negotiation RJ45 port. Used to connect to a switch, computer, or other wired devices.
4	POE LAN/WAN	PoE power input and data transmission port. If the device works in Router mode, it is a WAN port. Otherwise, it is a LAN port. Use the included PoE injector to supply power to the device.
5	/	Ethernet cable inlet.

- Package Contents**
- CPE9 \*1
  - PoE Injector \*1
  - Power Adapter \*1
  - Ethernet Cable \*1
  - Quick Installation Guide \*1
  - Grounding Screw \*1
  - Pole Mounting Strap \*2
  - Screw \*2 (Used to fix the PoE injector)
  - Expansion Anchor \*2 (Used to fix the PoE injector)
  - Quick Installation Guide \*1
- Please read this quick installation guide before you start. You can visit our website at <http://www.ip-com.com/cn/> for more information about the device.

**Application Scenario 1: CCTV Surveillance or Point to Point Data Transmission**

**1. Set up the Devices (AP + Station Mode)** Tip: At least two devices are required for bridging.

**Method 1: Automatic Bridging (Recommended)**

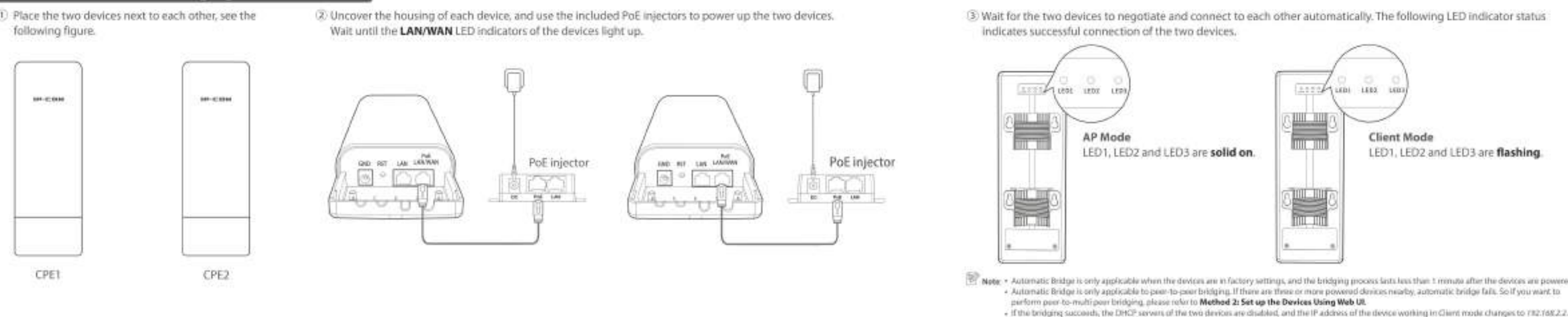

**Method 2: Set up the Devices Using Web UI**

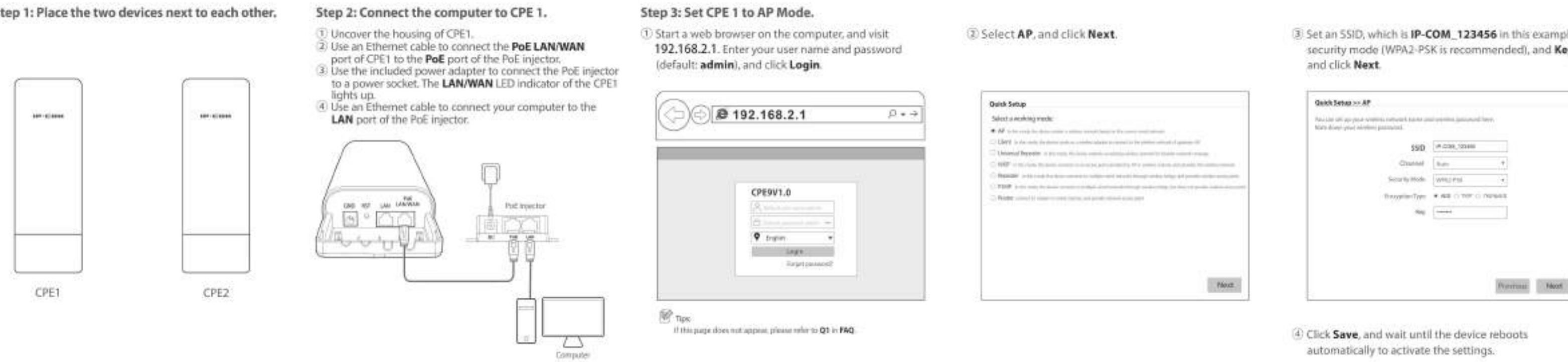

**2. Install the Devices**

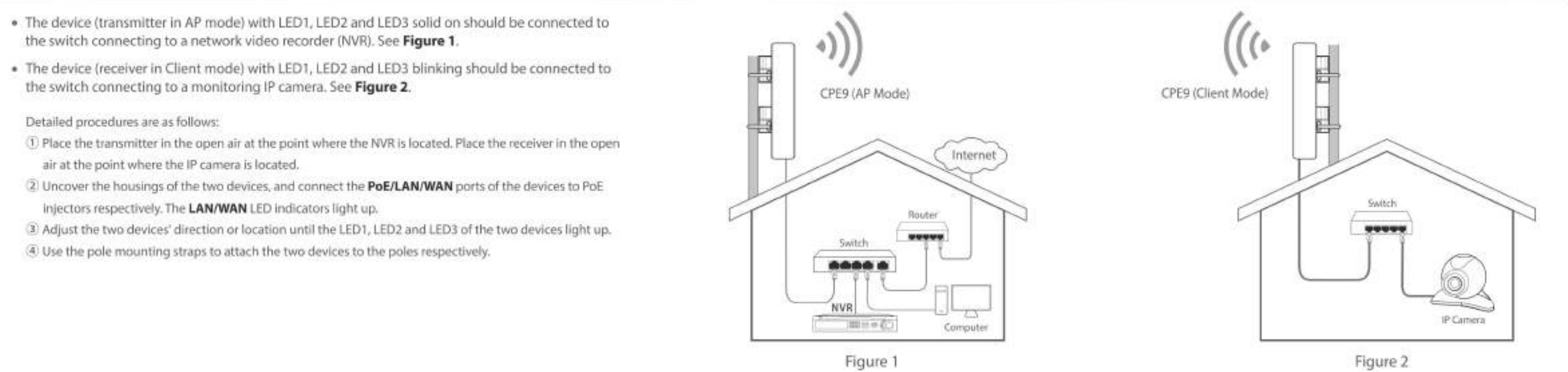

**Application Scenario 2: Wireless ISP Hotspot Access**

**1. Set up the Device**

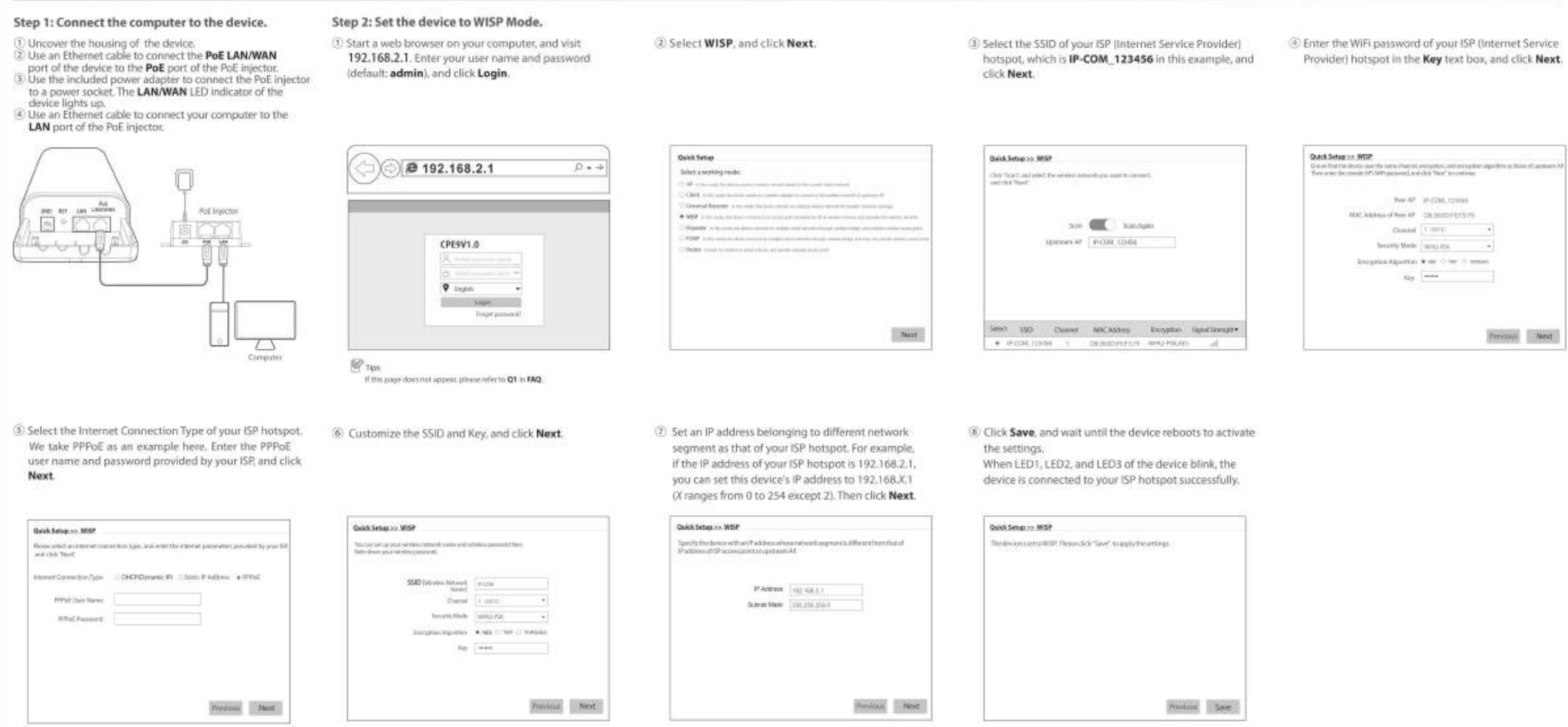

**2. Install the Devices**

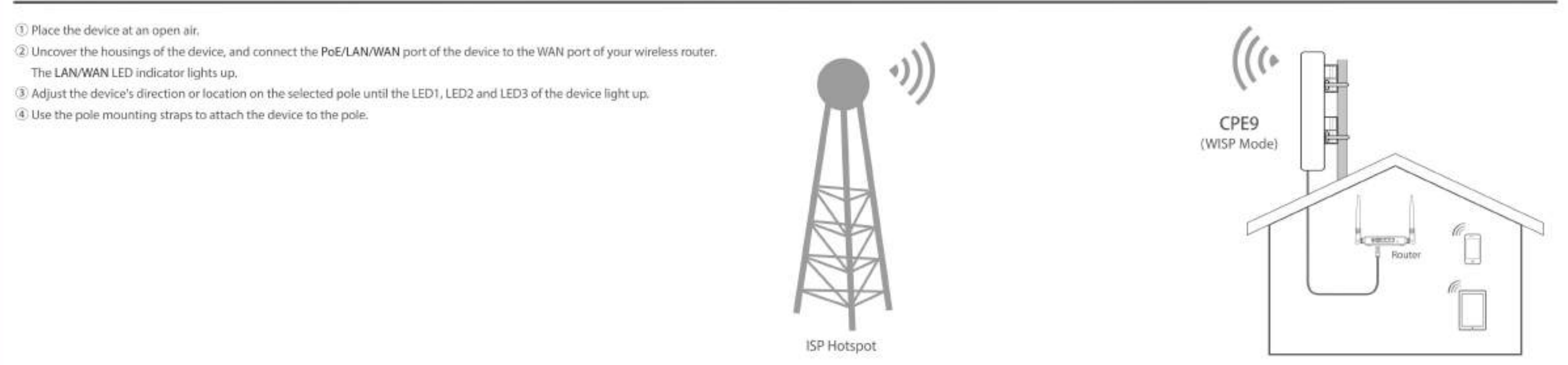

**FAQ**

- Q1: I cannot log in to the web UI of the device by entering 192.168.2.1. What should I do?**
- Try the following methods and try again:
    - Ensure that the device has been connected to the power supply and the computer properly.
    - Ensure that the IP address of the login computer is 192.168.2.X (X ranges from 2 to 254).
    - Reset the device to factory settings.
- Q2: How to reset the device to factory settings?**
- Note: Resetting the device will clear all settings, and you need to configure it again.
  - Method One: 1 minute after the device is powered on, uncover the housing of the device, and hold down the Reset button for about 8 seconds. When all LED indicators light up, the device is restored to factory settings.
  - Method Two: Log in to the web UI of the device, choose Tools > Maintenance, and click Reset button.
- Q3: How to determine whether the bridging signal is optimal when the devices are used for CCTV surveillance?**
- Method One: Observe the LED indicators of the two devices. The bridging signal is optimum when all of the LED1, LED2 and LED3 indicators are solid on or flashing.
  - Method Two: Log in to the web UI of one device (default login address: 192.168.2.1), choose Status, and check the wireless status on the following page:

Wireless Status	
Working Mode	Client
SSID	N/A
API MAC Address	DB:38:02:7E:57:9
Signal Strength	120dBm
Security Mode	N/A
Background Noise	95dBm
Channel/Radius Band	1/2412
TX/RX Link	TX:1
No. of Wireless Clients	N/A
Transmit/Receive Speed	720Mbps/204Mbps

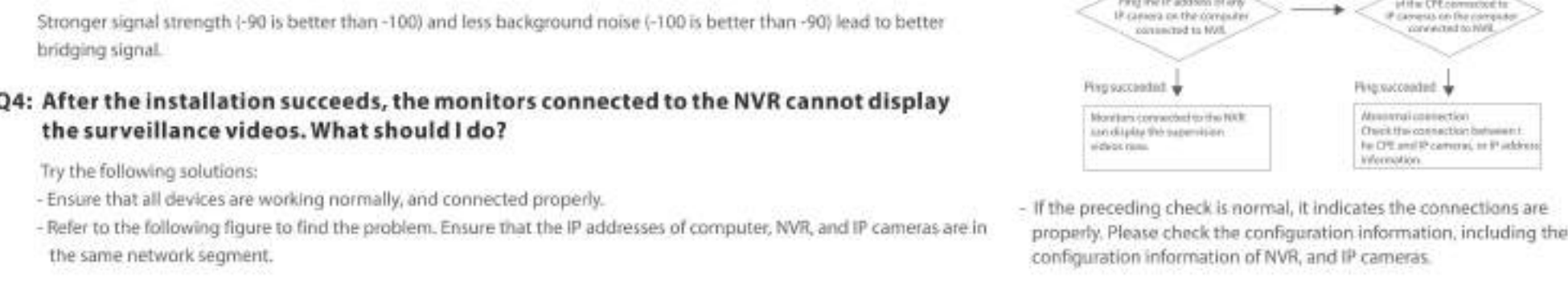

**CE Mark Warning**

This is a Class B product. In a domestic environment, this product may cause radio interference, in which case the user may be required to take adequate measures.

WARNING: The mains plug is used as disconnect device, the disconnect device shall remain readily operable.

NOTE: (1) The manufacturer is not responsible for any radio or TV interference caused by unauthorized modifications to this equipment. (2) To avoid unnecessary radiation interference, it is recommended to use a shielded RJ45 cable.

**Declaration of Conformity**

Hereby, SHENZHEN IP-COM Networks Co., Ltd. declares that the radio equipment type CPE9 is in compliance with Directive 2014/53/EU.

The full text of the EU declaration of conformity is available at the following internet address: <http://ip-com.com.cn/en/ce.html>

Operate Frequency: EU/2400-2483.5MHz (CH1-CH13)  
EIRP Power (Max.): 19.8 dBm  
Software Version: V1.0.0.1

**Caution:**  
Adapter Model: BN036-A12012E, BN036-A12012B, BN036-A12012U  
Manufacturer: SHENZHEN HEWEISHUN NETWORK TECHNOLOGY CO., LTD.  
Input: 100 - 240 V AC, 50/60 Hz 0.4 A  
Output: 12 V DC, 1 A  
==== DC Voltage

**FCC Mark Warning**

**FCC Statement**

This equipment has been tested and found to comply with the limits for a Class B digital device, pursuant to Part 15 of the FCC Rules. These limits are designed to provide reasonable protection against harmful interference in a residential installation. This equipment generates, uses and can radiate radio frequency energy and, if not installed and used in accordance with the instructions, may cause harmful interference to radio communications. However, there is no guarantee that interference will not occur in a particular installation. If this equipment does cause harmful interference to radio or television reception, which can be determined by turning the equipment off and on, the user is encouraged to try to correct the interference by one or more of the following measures:

- Reorient or relocate the receiving antenna.
- Increase the separation between the equipment and receiver.
- Connect the equipment into an outlet on a circuit different from that to which the receiver is connected.
- Consult the dealer or an experienced radio/TV technician for help.

This device complies with Part 15 of the FCC Rules. Operation is subject to the following two conditions: (1) this device may not cause harmful interference, and (2) this device must accept any interference received, including interference that may cause undesired operation.

**Radiation Exposure Statement**

This device complies with FCC radiation exposure limits set forth for an uncontrolled environment and it also complies with Part 15 of the FCC RF Rules.

**Caution:**

Any changes or modifications not expressly approved by the party responsible for compliance could void the user's authority to operate this equipment.

This transmitter must not be co-located or operating in conjunction with any other antenna or transmitter.

NOTE: (1) The manufacturer is not responsible for any radio or TV interference caused by unauthorized modifications to this equipment. (2) To avoid unnecessary radiation interference, it is recommended to use a shielded RJ45 cable.

**RECYCLING**

This product bears the selective sorting symbol for Waste electrical and electronic equipment (WEEE). This means that this product must be handled pursuant to European directive 2012/19/EU in order to be recycled or dismantled to minimize its impact on the environment. User has the choice to give his product to a competent recycling organization or to the retailer when he buys a new electrical or electronic equipment.

Operating Temperature: -30°C ~ 60°C  
Operating Humidity: (10~90)%RH, non-condensing

**Technical Support**

Address: Room 101, Unit A, First Floor, Tower E3, No.1801, Zhongshunqun Road, Nanshan District, Shenzhen, China 518052  
Tel: (86)755 2705 3089  
Email: [info@ip-com.com.cn](mailto:info@ip-com.com.cn)  
Website: <http://www.ip-com.com.cn/>

**Copyright**

© 2018 IP-COM Networks Co., Ltd. All rights reserved.  
This document (including pictures, images, and product specifications, etc.) is the property of the manufacturer. Reproduction, distribution, modification, and other unauthorized actions are prohibited. All rights reserved. Changes to the product are reserved. This document will be updated without notice any time or without announcement or change.