



COMMAX Co.,Ltd.

513-11, Sangdaewon-dong, Jungwon-gu, Seongnam-si, Gyeonggi-do, Korea

Int'l Business Dept. Tel. : +82-31-7393-540~550 Fax. : +82-31-745-2133

Web site : www.commax.com

Printed In Korea / 2011.01.103

Since 1968

Home Network
COMMAX

User Manual

DOOR STATION DR-2GN / 2GRN



www.commax.com

COMMAX Co.,Ltd.



- Thank you for purchasing COMMAX products.
- Please carefully read this User's Guide (in particular, precautions for safety) before using a product and follow instructions to use a product exactly.
- The company is not responsible for any safety accidents caused by abnormal operation of the product.

Table of Contents

| | |
|----------------------------------|---|
| 1. Greeting | 2 |
| 2. Overview | 3 |
| 3. Wiring and Installation | 4 |
| 4. Specification | 7 |

1. Greetings

- * Thank you for purchasing a COMMAX product.
- * Please read this manual before use and properly follow its instructions.

2.Overview

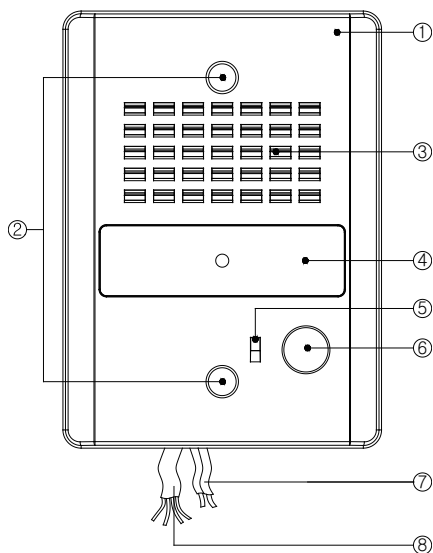

| No. | Name | Contents |
|-----|----------------------|--|
| 1 | Front case | |
| 2 | Stationary hole | |
| 3 | Speaker | transmits visitor' s voice (outdoor->indoor) |
| 4 | Operation Status LED | |
| 5 | Microphone | transmits householder' s voice(indoor-outdoor) |
| 6 | Call button | |
| 7 | Door Release CABLE | 12V \equiv Voltage output |
| 8 | CABLE | (White, Black -> Room station) |

3. Wiring & Installation

1. Connect Room station cables as appeared in the figure.(polarity with care)
2. Connect Door Release cable as appeared in the figure. (applied only for DR-2GR)
3. Check to see whether the system functions.

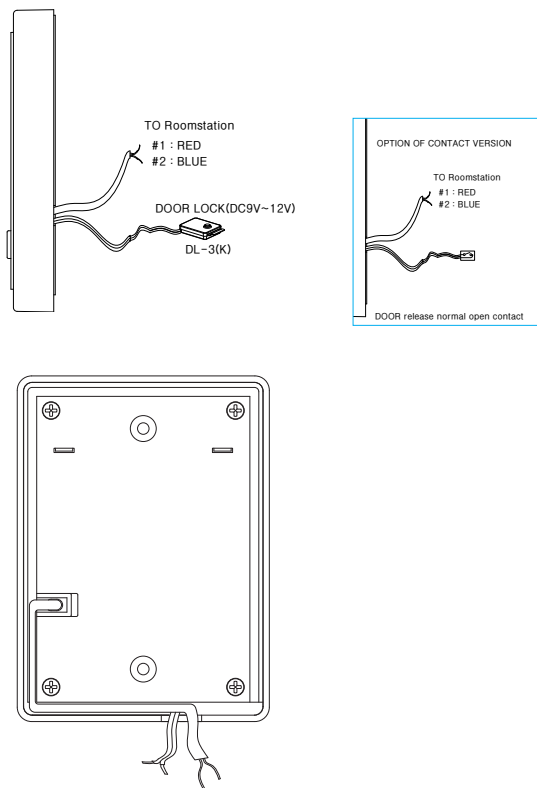

4. If there is no hole on the wall, you can allocate the wire on the groove around the case as appeared in the figure.

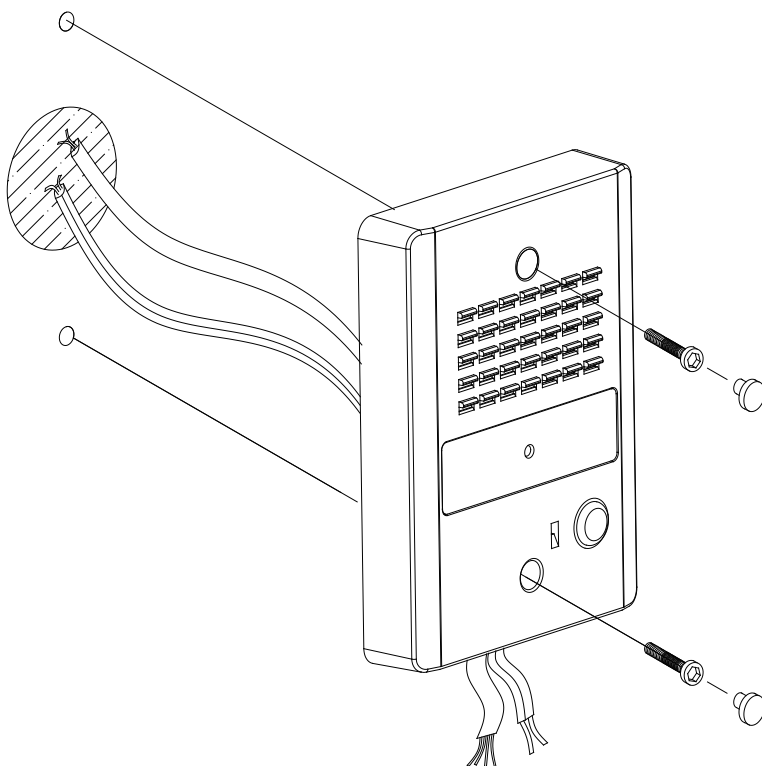

5. Place the system on the wall and mount with screws supplied.

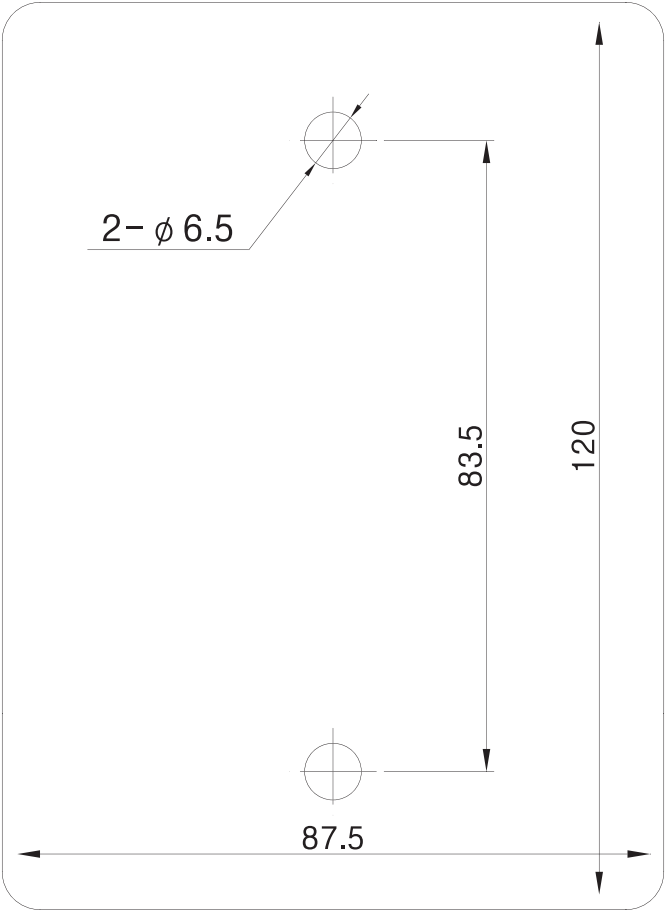

< In case of taking the cover off >

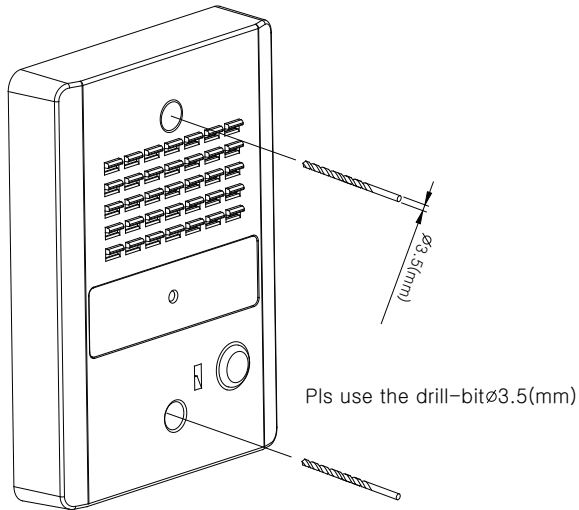

4. Specification

| specification | Model | DR-2GN/2GRN |
|---------------------------|--|-------------|
| Wiring System (household) | DOOR PHONE 2-wire system | |
| Communication method | Synchronous Call System | |
| Rated voltage | 9V \equiv (Supplied from the DOOR PHONE) | |
| Operating Temperature | -10℃ ~ +40℃ | |
| Dimensions | 93.5(W) × 126(H) × 18(D) | |
| Weight (g) | 170 | |
| Communication distance | 50m / ϕ 0.8 | |