

ProBio

Multi-Biometric Access Control Terminal



ProBio is the first access control terminal to apply the most advanced Silk ID and face technology together. Silk ID not only has outstandingly high identification rate towards dry, wet, and rough fingers, but also provides the utmost security with alive finger detection. It can operate under strong light, and activates automatically when finger approaches to save power.

Using ZKTeco's latest ZKFACE version 7.0 high-speed face recognition algorithm, it has extremely high verification speed and low error rate, in addition to being able to effectively prevent duplicated registration.

In addition, the new ZMM 220 hardware platform has a clock rate of 1.2 GHZ, greatly enhancing the speed of fingerprint and face verification. Such speedy hardware platform and fingerprint and face algorithm greatly enhance the speed of fingerprint and face verification.

Features



Revolutionary SilkID
Fingerprint Sensor



Multiple Verification Modes:
Face / Fingerprint /
Card / Password



Outstanding Performance With
Dry, Wet and Rough Fingers



Simple Management & Scalability



Built In Camera
* Event Snapshot
* User Photo



Specifications G: GL Exclusive Feature)

Capacity

Fingerprints	4,000
Faces	2,000 (1:N) / 4,000 (1:1)
Cards	10,000
Transactions	100,000
User Photos	4,000
Event Photos	2,000

Communication

- G TCP/IP, RS485 (For Slave Reader)
- USB Host
- Wiegand Input / Output
- Security Relay Box

Access Control Interface

Lock Relay Output
Alarm Output / Auxiliary Input
Exit Button / Door Sensor
Doorbell Output

Hardware

- G 1.2GHz High Speed CPU
- G Memory 128MB RAM / 256MB Flash
- SilkID Fingerprint Sensor
- G 2.8 Inches TFT-LCD Touch Screen
- 125KHz EM Reader / Mifare (Optional)
- Hi-Fi Voice & Indicator
- Tamper Switch Alarm
- G Dual IR Camera

Standard Functions

Access Levels / Groups / Holidays
DST / Bell Schedule
Duress Mode
Anti-Passback
Record Query
Custom Wallpaper & Screen Saver

Special Functions

- G Multiple Biometric Verification Modes
- G Alive Finger Detection
- G Event Snapshot
- User Photo
- ZK Encrypted Card (Optional)
- Fingerprint Card

Compatibility

- Wiegand Slave Reader
- G RS485 FP Slave Reader
- ZKBioSecurity Software

Additional Info

Working Temperature: -10 °C ~ 50 °C
Dimensions: 190.8 × 85 × 103 mm
ZKFace v7.0 & ZKFinger v10.0 Algorithms
Fingerprint: FAR≤0.0001% FRR≤0.01%
Face: FAR≤0.001% FRR≤1%
Package Includes 12V 3A Power Supply

Power

Operating Voltage 12V DC
Current Draw < 500mA

Configuration

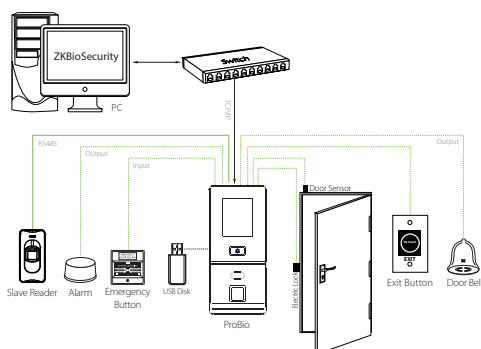

Dimensions (mm)

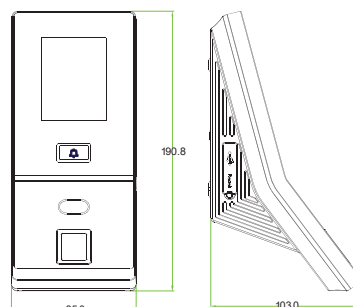

ZKTeco Europe
www.zkteco.eu
E-mail: sales@zkteco.eu



© Copyright 2016, ZKTeco Inc. ZKTeco Logo is a registered trademark of ZKTeco or a related company. All other product and company names mentioned are used for identification purposes only and may be the trademarks of their respective owners. All specifications are subject to change without notice. All rights reserved.